

Galanz

Commercial Air Conditioner

*Galanz always
belongs to you*



Galanz

Galanz(Zhongshan) Electrical Appliances Ltd.

Add: No.3 Xingpu Road East, Huangpu Town, Zhongshan City, Guangdong, China

Tel: +86-760-23306841 Fax: +86-760-23306803 ZIP: 528429

Http://www.galanz.com E-mail: aircon@galanz.com.cn

2011 Collection





Introduction of Galanz A/C



Galanz Group Profile

Year of Establishment: 1978
 Employees: 42,000 people
 Turnover: 4.5 billion USD (2010)
 Main Products:

- Microwave oven
- Air Conditioner
- Home appliances

● Galanz Commercial Air Conditioner

Galanz Commercial Air Conditioner
 Year of Establishment: 2007
 Employees: 1000 people
 Production Capacity: 1 million sets/year

● Galanz Residential Air Conditioner

Galanz Residential Air Conditioner
 Year of Establishment: 2000
 Employees: 12,000 people
 Factory size: 2,000,000 Square meters
 Production Capacity: 5 million sets/year

Industries Covered: Air conditioner assembly, heat exchanger, PCB, Motor, plastic component, compressor, metal assembly, molding, etc.

Light Wave Anti Virus!!!

Light wave virus-killer
Ensure more comfortable and high-quality air

Patent No.: ZL031138667

LIGHT WAVE: Galanz exclusively owned healthy technology with high bacteria killing efficiency of 99.43%. A light wave generator is put inside the evaporator. When it is running it can create a kind of light wave in 750-1000 nm length, which can efficiently kill the bacteria both inside the evaporator and in the airflow. Bacteria DNA can be broken and converted into CO₂ and H₂O, which is no second pollution to the air and health. A testing by Guangdong Disease Prevention and Control Center has indicated that the bacterial killing efficiency can reach 99.43% and it is fully ecological. Besides bacterial killing, during heating mode in winter light wave function can also work as an electrical heating element, then the heating capacity can be increase greatly. Galanz light wave is absolutely the best healthy solution to your room-air treatment!

ONE PCB FOR ALL

ONE PCB compatible for
ALL types of indoor units,
ALL capacities,
ALL Refrigerants,
Easy for maintainance

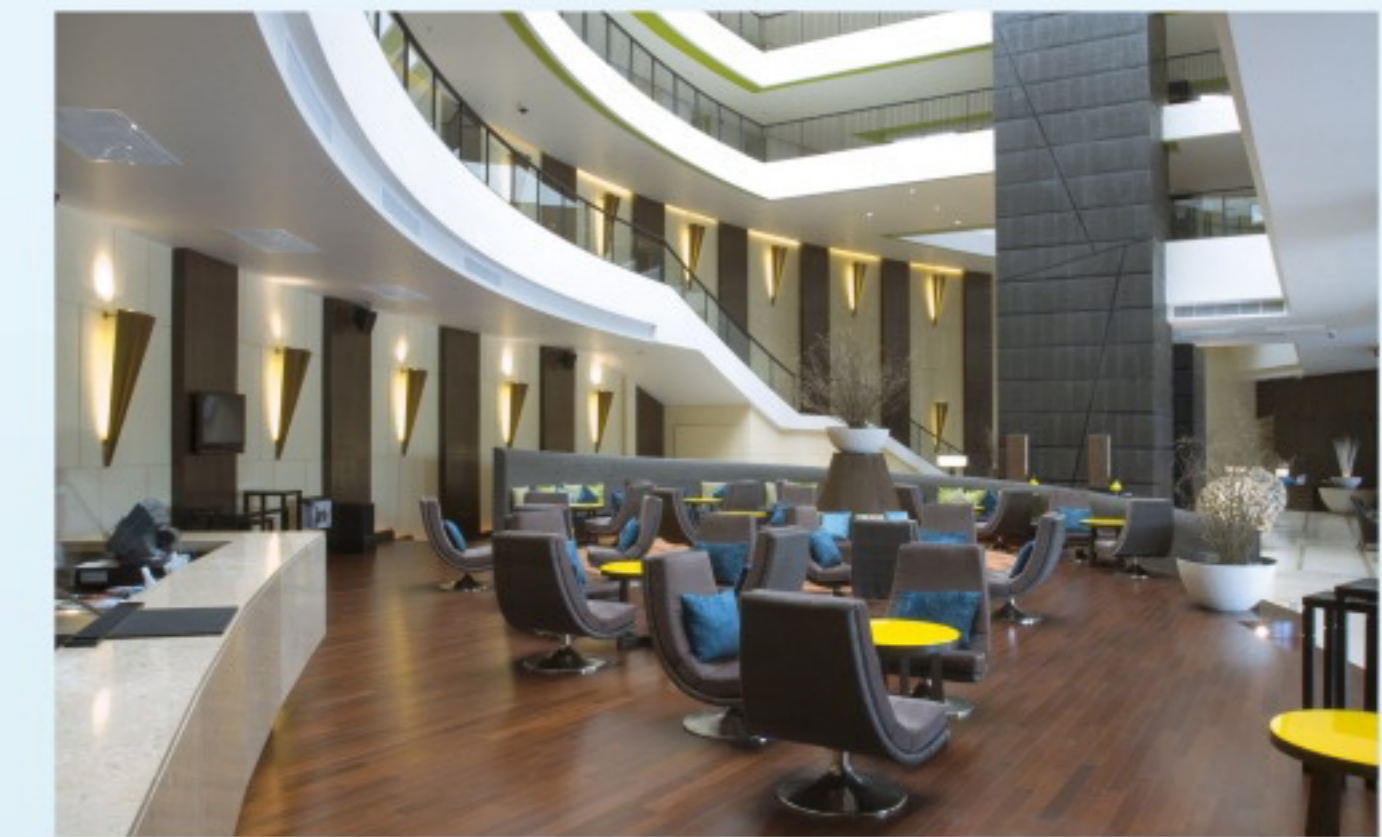

Commercial Air Conditioner

R410A Commercial Aircon Line-up

Capacity (Btu/h)		12,000	18,000	24,000	36,000	48,000	60,000		
R410A ON/OFF Unitary	4-way cassette							13	
	Ceiling-floor							15	
	Low static pressure duct								17
	Medium static pressure duct								17
	High static pressure duct								17
	ON/OFF Universal outdoor unit								11
R410A DC Inverter Unitary	4-way cassette							23	
	Ceiling-floor							25	
	Medium static pressure duct							27	
	DC Inverter universal outdoor unit							21	

Commercial Air Conditioner

R410A Commercial Aircon Line-up

Capacity		2.2kw	2.8kw	3.6kw	4.5kw
R410A DC Inverter VRF System	4-way cassette				
	Ceiling-floor				
	Low static pressure duct				
	Medium static pressure duct				
	Wall-mounted				
	Capacity	25.5kw	28.0kw	33.5kw	40.0kw
	DC Inverter Modular VRF outdoor				
Capacity		12.0kw			
R410A Air-cooled Chiller	Mini Chiller				
	Modular Chiller	30.0kw	40.0kw		
Terminal	Fan Coil				
Capacity		3.0~5.3kw			
R410A Heat Pump Water Heater					

5.6kw	7.1kw	8.0kw	9.0kw	10.0kw	11.2kw	14kw		
							33	
							34	
							35	
							36	
							38	
Capacity								
45.0kw								
							31	
Capacity		15.0kw		20.0kw		25.0kw		
							41	
Capacity		50.0kw	65.0kw	75.0kw	100.0kw	130.0kw	150.0kw	200.0kw
								42
								45
Capacity		3.5~7.2kw						
								51
								52



R410A ON/OFF Unitary

How to read the models

1. R410A ON/OFF Unitary

2. R410A DC Inverter Unitary

3. R410A DC Inverter VRF

4. R410A Air-cooled Chiller and Terminal

5. R410A Heat Pump Water Heater

Indoor Unit

GD-36HMRST/ U

① | ② | ③ | ④ | ⑤ | ⑥ | ⑦ | ⑧ | ⑨ | ⑩

- ①..... Galanz
- ②..... Indoor Unit Type
C:Cassette D:Duct Type
U:Ceiling floor
- ③..... Nominal Capacity(36,000Btu/h)
- ④..... Function Code
C:Cooling Only
H:Heat Pump E:Auxiliary Heater
- ⑤..... Static pressure Code
/ :Low Static Pressure
M:Medium Static Pressure T:High Static Pressure
- ⑥..... F:R22 R:R410A
- ⑦..... Power Supply
/ :220~240V 1PH 50Hz S:380V 3PH 50Hz
- ⑧..... Indoor Unit
- ⑨..... A:Automatic Air Swing H:Manual Air Swing
- ⑩..... Universal Outdoor design

Outdoor Unit

GW-36HRS

① | ② | ③ | ④ | ⑤ | ⑥

- ①..... Galanz
- ②..... Outdoor Unit Type
W:Universal Horizontal Discharge Condensing Unit
T:Universal Vertical Discharge Condensing Unit
- ③..... Nominal Capacity(36,000Btu/h)
- ④..... Function Code
C:Cooling Only
H:Heat Pump E:Auxiliary Heater
- ⑤..... F:R22 R:R410A
- ⑥..... Power Supply
/ :220~240V 1PH 50HZ S:380V 3PH 50HZ

R410A ON/OFF Unitary Universal Outdoor Unit Series



12,000 Btu/h



18,000 Btu/h



24,000 Btu/h



36,000 Btu/h



48,000 Btu/h



60,000 Btu/h



Specification

Model		GW-12HR	GW-18HR	GW-24HR	GW-36HRS	GW-48HRS	GW-60HRS
Capacity	Cooling (Btu/h)	12000	18000	24000	36000	48000	60000
	Heating (Btu/h)	13200	19800	26400	39600	52800	66000
Power Supply	V/PH/Hz	220-240/1/50	220-240/1/50	220-240/1/50	380V/3/50	380V/3/50	380V/3/50
Performance	Air Volume (m ³ /h)	1500	2100	2800	3800	5000	5800
	Noise Level dB(A)	53	56	58	59	62	63
Refrigerant	Type	R410A/1.1	R410A/1.9	R410A/2.1	R410A/2.95	R410A/3.3	R410A/3.8
Unit Size (WxHxD)	Net Dimension (mm)	700x540x255	800x670x300	845x680x310	880x790x360	970x928x345	973x1239x350
	Packing Dimension (mm)	800x375x620	1010x775x430	1010x755x430	1030x890x480	1095x1070x470	1065x1390x435
Weight	Net Weight (kg)	30	50	64	70	91	106
	Gross Weight (kg)	33.5	55	69	80	102	115
Piping Dia	Liquid Side (mm)	6.35(1/4")	6.35(1/4")	9.52(3/8")	9.52(3/8")	9.52(3/8")	9.52(3/8")
	Gas Side (mm)	12.7(1/2")	12.7(1/2")	15.88(5/8")	19.05(3/4")	19.05(3/4")	19.05(3/4")
	Max pipe length(mm)	25	25	30	30	50	50
	Max piping fall(mm)	10	10	15	15	30	30
Stuffing Quantity	20/40/40HQ	132/276/368	90/186/186	90/186/186	48/100/150	48/100/100	27/56/56

Remark: The above designs and specifications might be changed without prior notice for product improvement.



R410A ON/OFF Unitary Four-way Cassette Indoor Series



Detachable corners enable easy access to control parts when installing and maintaining. One-step panel can be fitted without any tool.

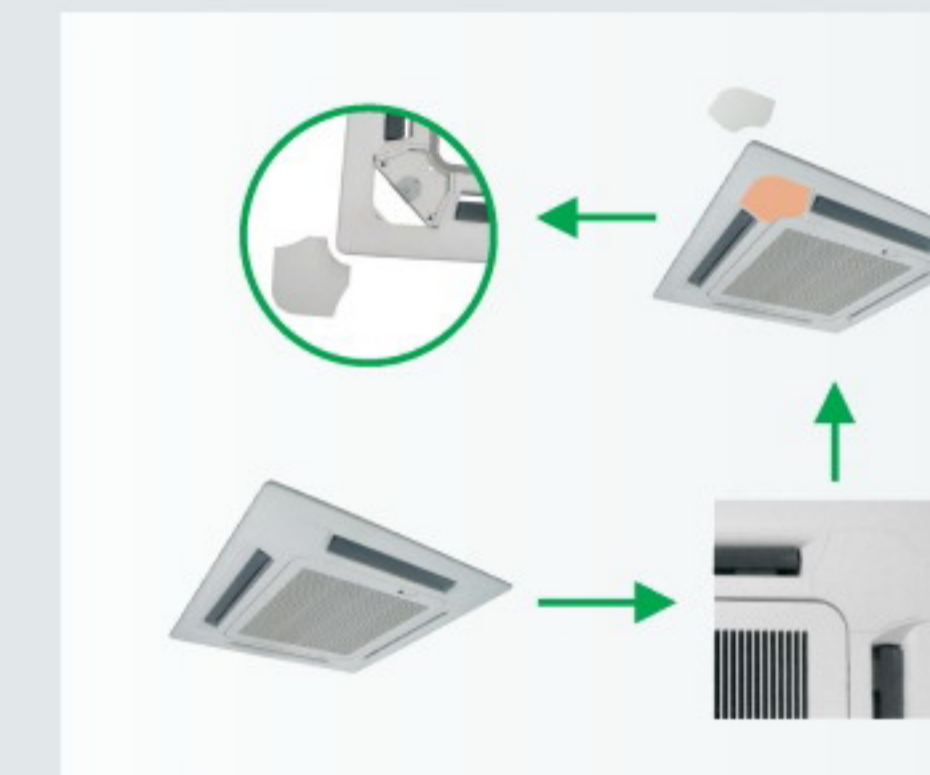

4 way air discharge ensures better air distribution and circulation in the room, with effective blowing height 3.5m

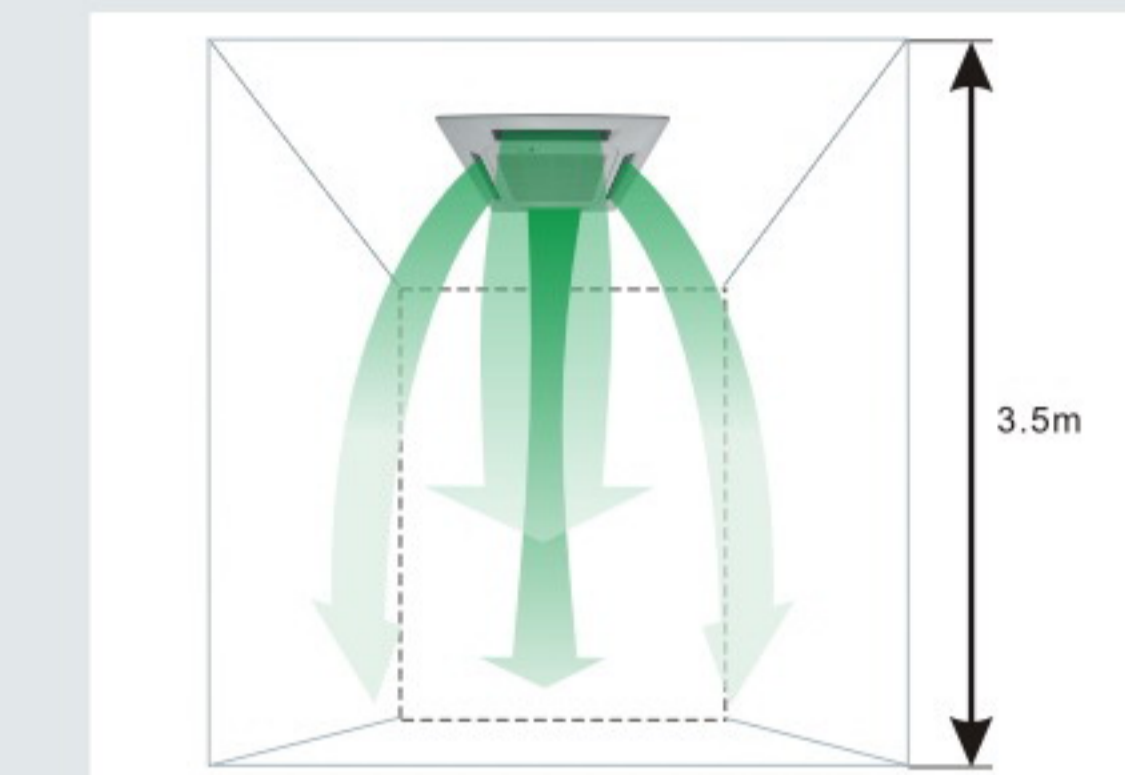

Using indoor piston orifice throttling instead of outdoor capillary, makes the whole system performance more stable and efficient.

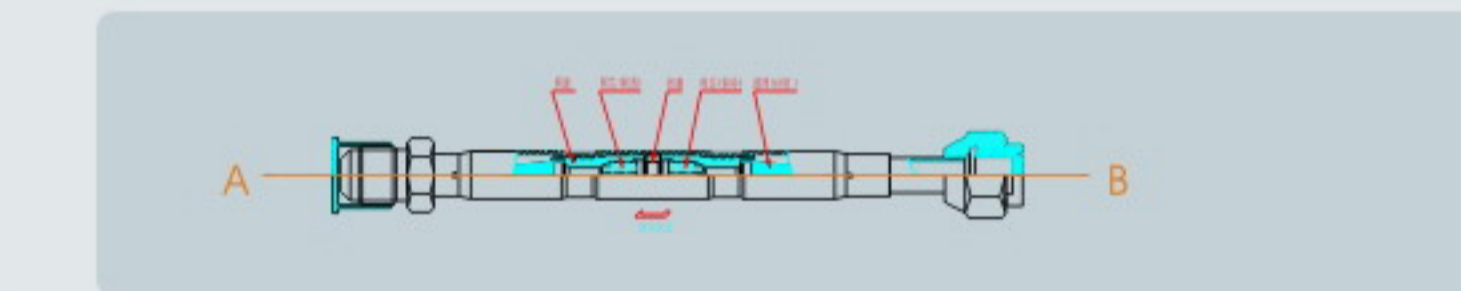
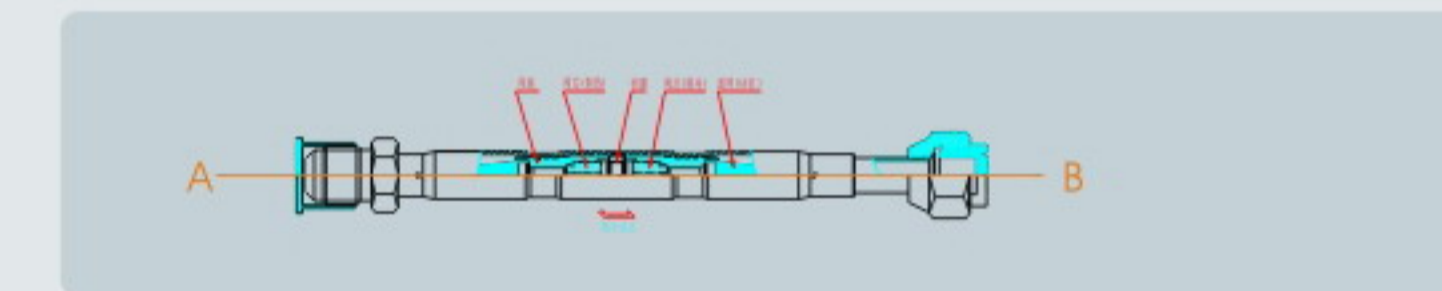

Compact design for 18k type, suitable for easy ceiling installation, no more additional work needed.

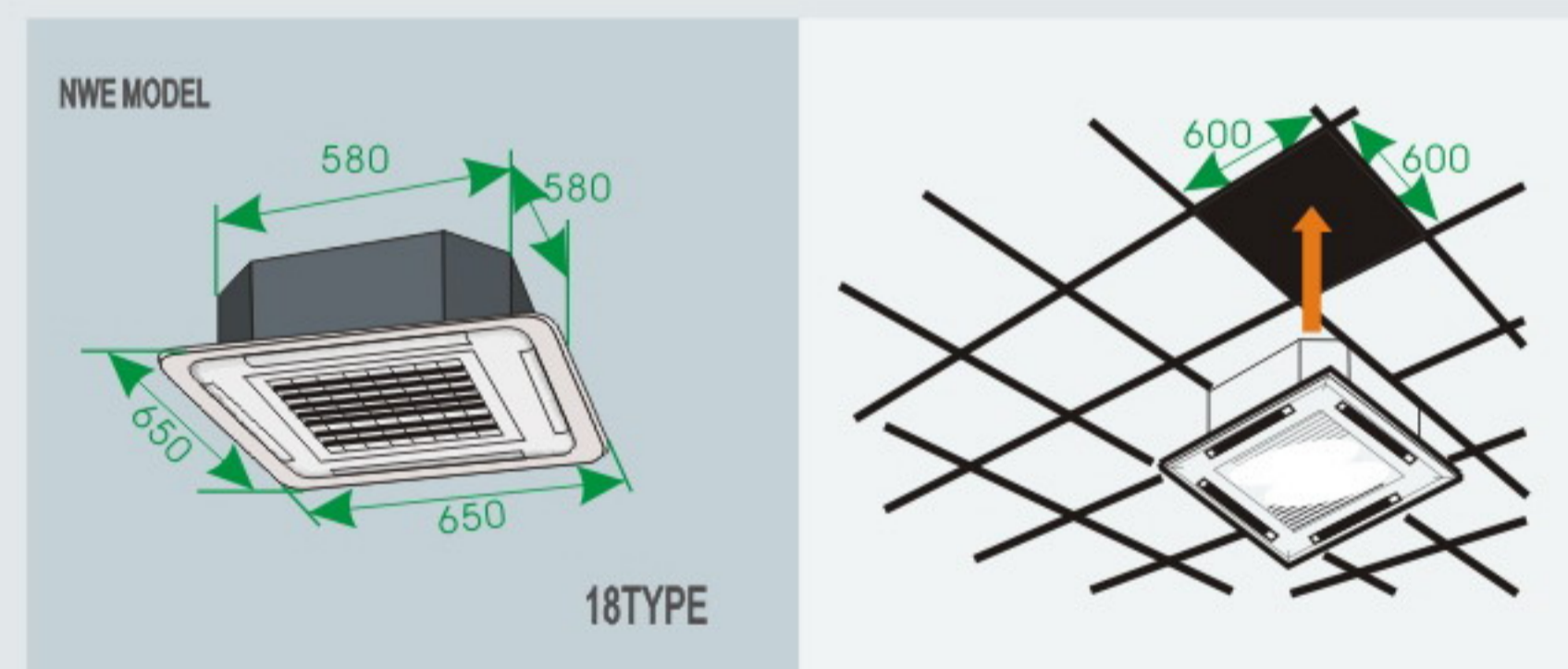

Four stepping motors. One stepping motor for each vane, makes it's moving easier and safer

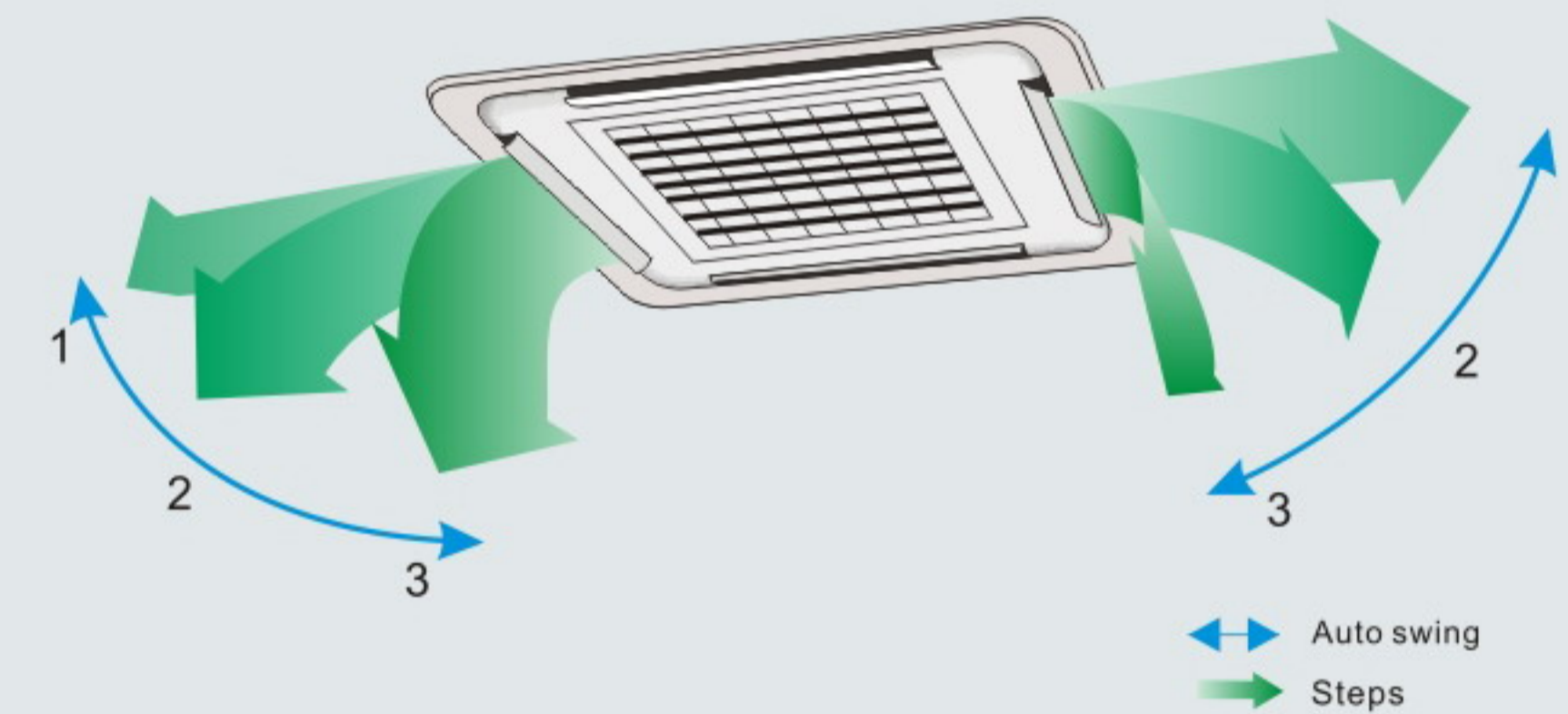

Auto swing and 3 steps of swing positions controlled by controller, standard mode, anti-direct blow mode, anti-ceiling blow mode

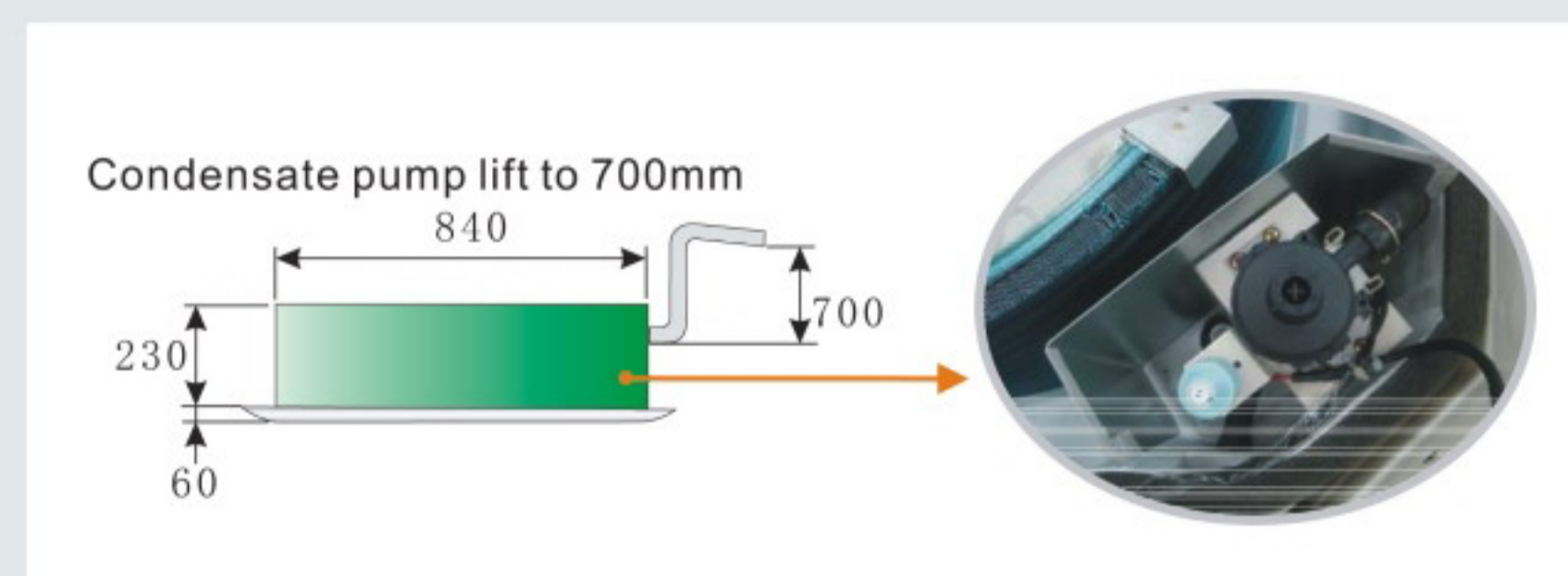

Built-in drain pump, makes the condensing water drainage easier and safer

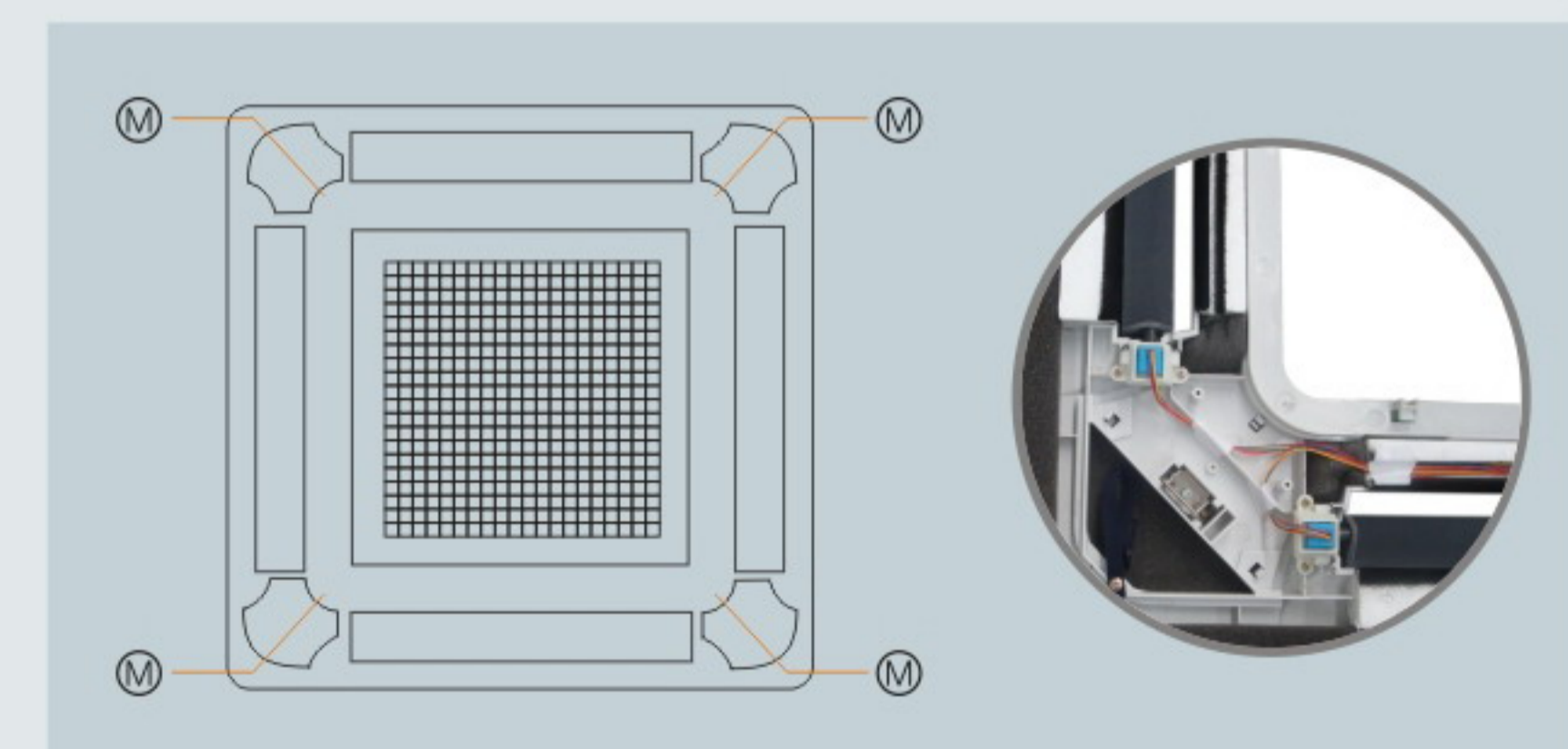

Specification

Model		GC-18HRT/U	GC-24HRT/U	GC-36HRST/U	GC-48HRST/U
Capacity	Cooling (Btu/h)	18000	24000	36000	48000
	Heating (Btu/h)	19000	26000	39600	52800
Power Supply	V/PH/Hz	220-240/1/50	220-240/1/50	220-240/1/50	220-240/1/50
	Air Volume (m3/h)	800	1200	1680	1800
Performance	Noise Level dB(A)	42	45	45	52
	Perfigerant	Type	R410A	R410A	R410A
Unit Size (WxHxD)	Net Dimension (mm)	570x255x570	840x230x840	840x305x840	840x305x840
	Packing Dimension (mm)	710x310x710	950x345x940	950x415x940	950x415x940
Panel Size (WxHxD)	Net Dimension (mm)	650x30x650	953x40x953	953x40x953	953x40x953
	Packing Dimension (mm)	760x100x760	1030x135x1030	1030x135x1030	1030x135x1030
Weight	Net Weight(Unit) (kg)	23	27	33	35
	Net Weight(Panel) (kg)	2	6	6	6
	Gross Weight(Unit) (kg)	25	36	43	45
	Gross Weight(Panel) (kg)	4	9	9	9
Piping Dia	Liquid Side (mm)	6.35(1/4")	9.52(3/8")	9.52(3/8")	9.52(3/8")
	Gas Side (mm)	12.7(1/2")	15.88(5/8")	19.05(3/4")	19.05(3/4")
	Drainage Pipe (mm)	Φ32	Φ32	Φ32	Φ32
Stuffing Quantity	20/40/40HQ	126/288/306	47/118/134	43/105/116	43/105/116

Remark: The above designs and specifications might be changed without prior notice for product improvement.

R410A ON/OFF Unitary Ceiling-floor Indoor Series



Manual or automatic control of the air outlet louver available



LED digital display



Slim and compact design, four different body sizes

SIZE	A	B	C
12k/18k/24k	1016	776	818
30k/36k	1316	1076	1118
48k	1616	1376	1418
60k	1916	1676	1718

Ceiling and floor installing optional carter for different interior design requirements.

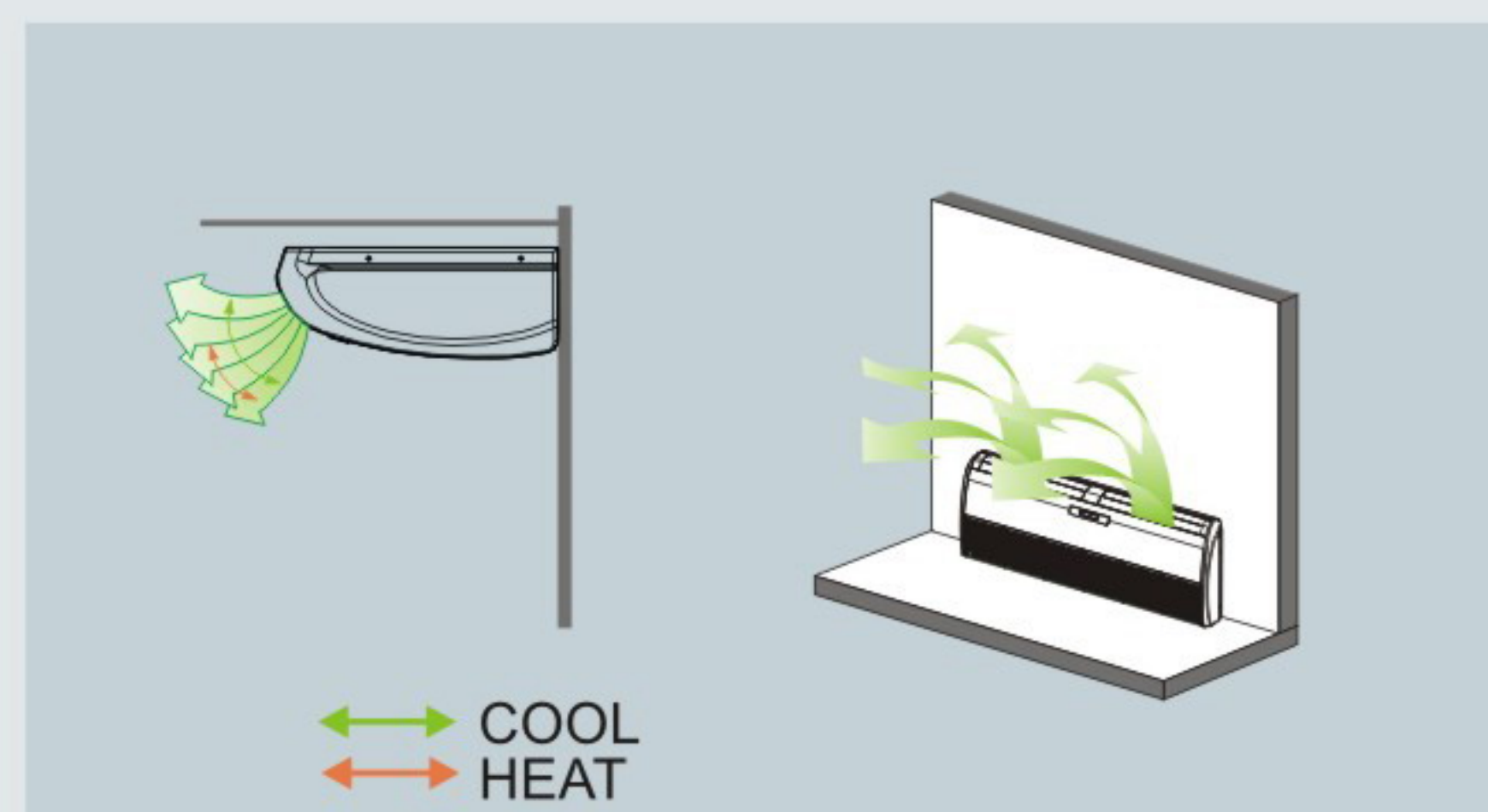

Horizontal and vertical wide-angle swing directions.

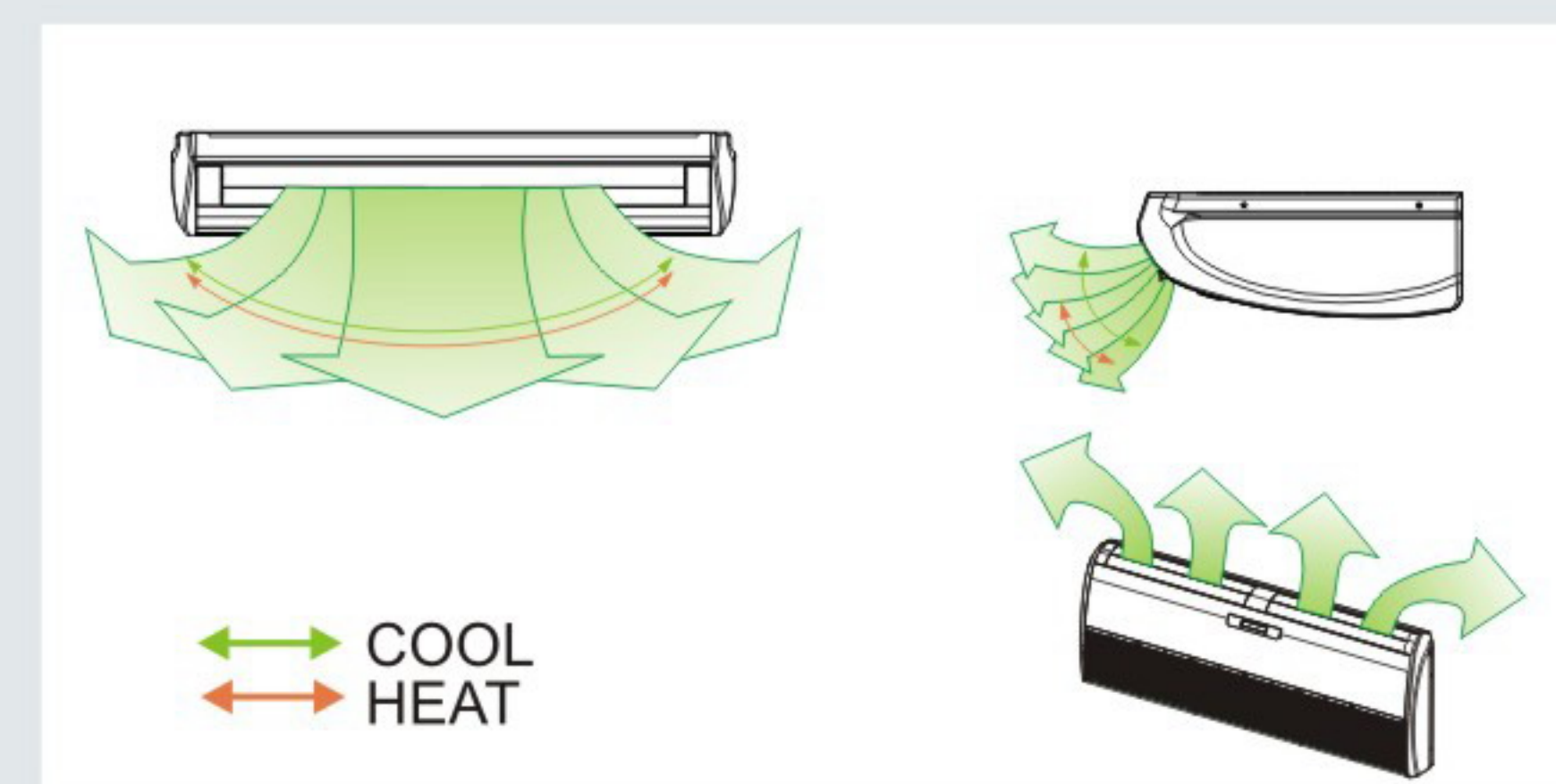

Special side-panel design for control box and pipe connection makes installation and maintenance more convenient.



Easy accessible filter when cleaning

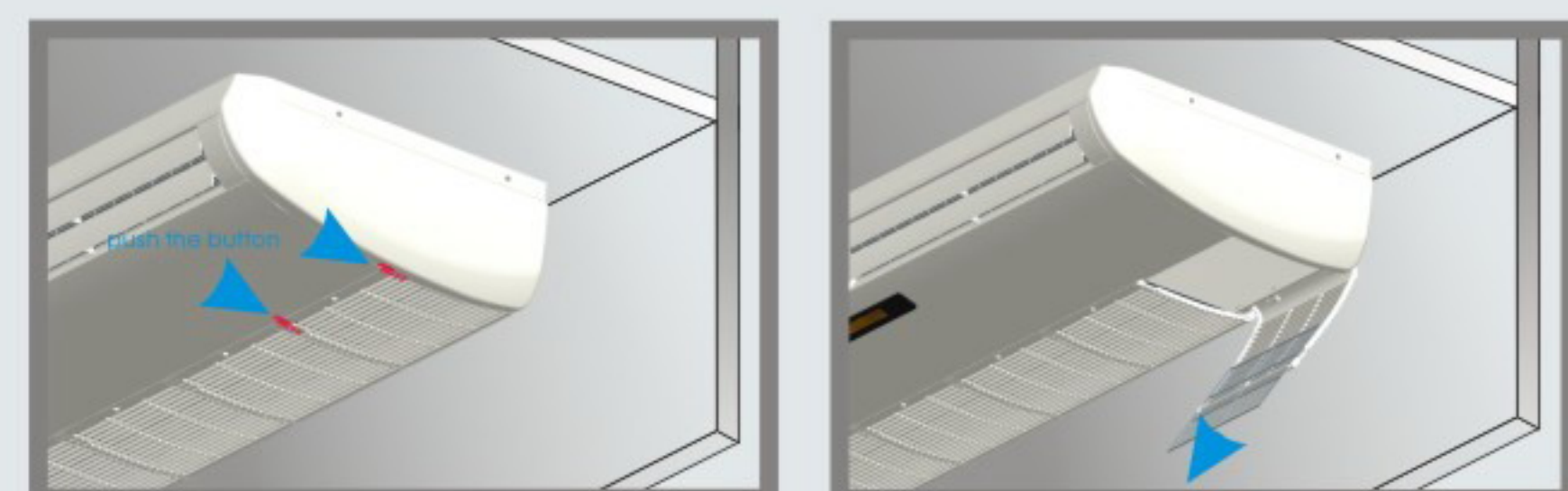

Specification

Model		GU-12HRT/AU GU-12HRT/HU	GU-18HRT/AU GU-18HRT/HU	GU-24HRT/AU GU-24HRT/HU	GU-36HRST/AU GU-36HRST/HU	GU-48HRST/AU GU-48HRST/HU	GU-60HRST/AU GU-60HRST/HU
Capacity	Cooling (Btu/h)	12000	18000	24000	36000	48000	60000
	Heating (Btu/h)	13200	19800	26000	39000	52000	66000
Power Supply	V/PH/Hz	220-240/1/50	220-240/1/50	220-240/1/50	220-240/1/50	220-240/1/50	220-240/1/50
	Performance	Air Volume (m ³ /h)	600	850	1100	1550	2000
Refrigerant	Noise Level dB(A)	42	42	44	48	49	52
	Type	R410A	R410A	R410A	R410A	R410A	R410A
Unit Size (WxHxD)	Net Dimension (mm)	1016x240x630	1016x240x630	1016x240x630	1316x240x630	1616x240x630	1916x240x630
	Packing Dimension (mm)	1085x280x700	1085x280x700	1085x280x700	1385x280x700	1685x280x700	1985x280x700
Weight	Net Weight (kg)	32	34	34	45	56	70
	Gross Weight (kg)	37	39	39	50	62	78
Piping Dia	Liquid Side (mm)	6.35(1/4")	6.35(1/4")	9.52(3/8")	9.52(3/8")	9.52(3/8")	9.52(3/8")
	Gas Side (mm)	12.7(1/2")	12.7(1/2")	15.88(5/8")	19.05(3/4")	19.05(3/4")	19.05(3/4")
	Drainage Pipe (mm)	φ19.05	φ19.05	φ19.05	φ19.05	φ19.05	φ19.05
Stuffing Quantity	20/40/40HQ	142/298/332	142/298/332	142/298/332	111/226/251	91/189/210	77/162/180

Remark: The above designs and specifications might be changed without prior notice for product improvement.

R410A ON/OFF Unitary Duct Type Indoor Series



(Optional)



Wide range of applications. suitable for places such as restaurants, concert halls and hotels.



Two air intake methods: air intake from below or from rear.

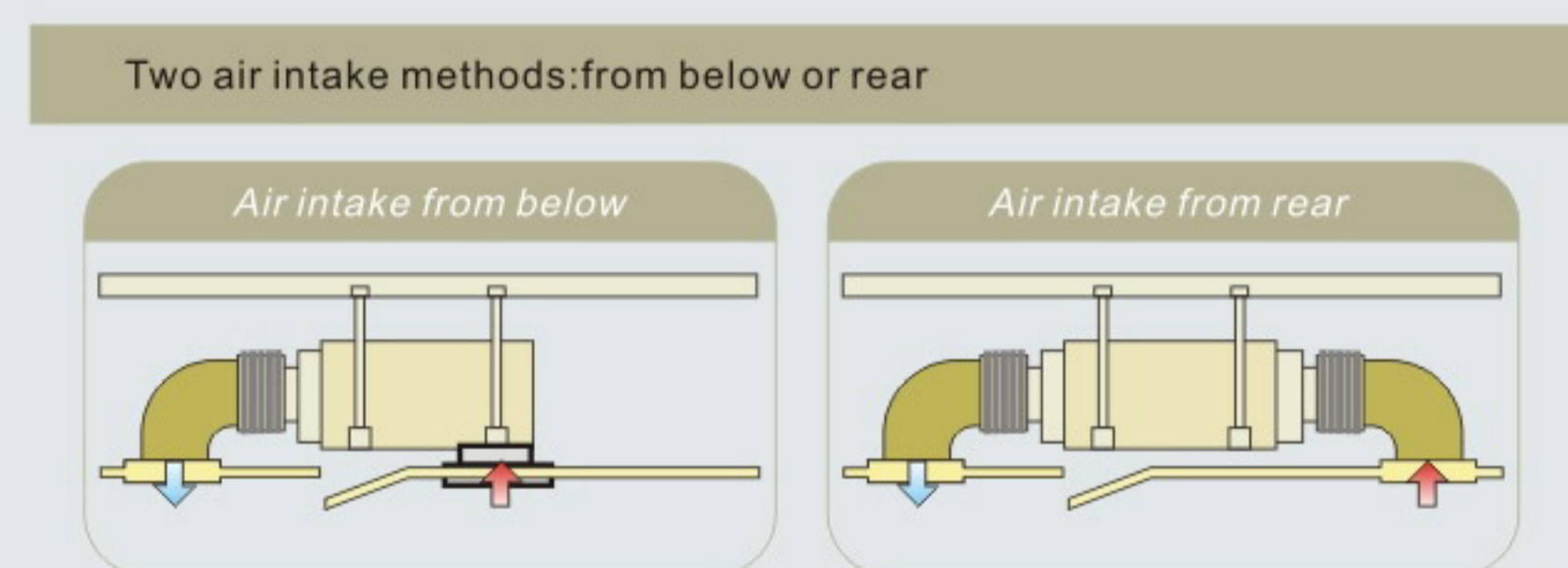

Special design of drain pan to prevent leakage of drain water

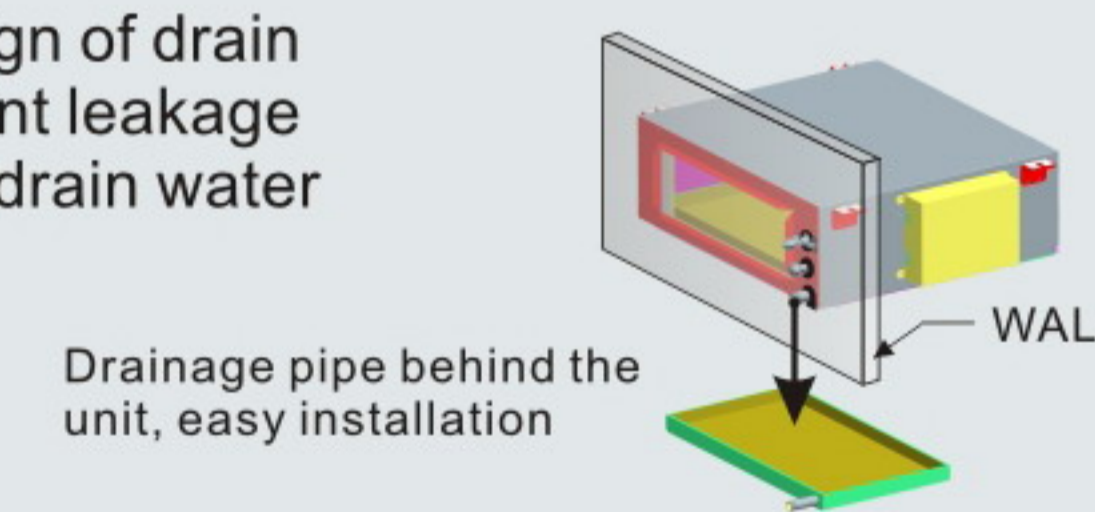

Three fan speeds available

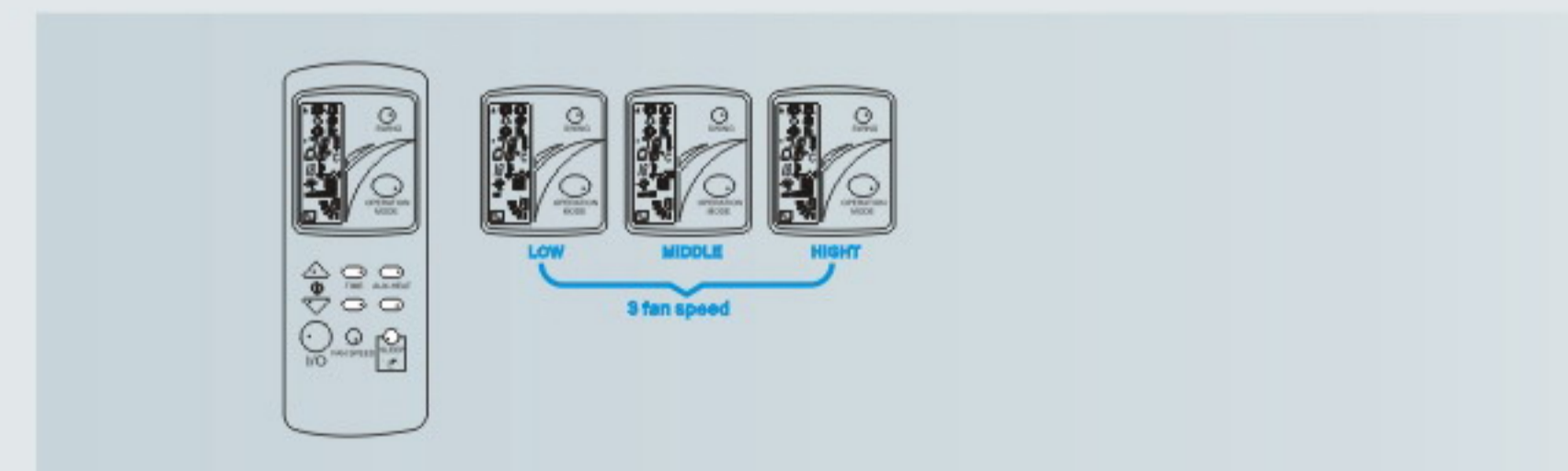

Low static pressure duct

Model		GD-12HRT/U	GD-18HRT/U	GD-24HRT/U	GD-36HRST/U	GD-48HRST/U
Capacity	Cooling (Btu/h)	12000	18000	24000	36000	48000
	Heating (Btu/h)	13200	19800	26400	39600	52800
Power Supply	V/PH/Hz	220-240/1/50	220-240/1/50	220-240/1/50	220-240/1/50	220-240/1/50
	Air Volume (m³/h)	550	850	1200	1550	1900
Performance	External static pressure (Pa)	30	30	30	30	30
	Noise Level dB(A)	40	42	42	50	50
Refrigerant	Type	R410A	R410A	R410A	R410A	R410A
Unit Size (WxHxD)	Net Dimension (mm)	815x240x290	1000x240x490	1130x240x490	1715x240x490	1715x240x490
	Packing Dimension (mm)	845x275x530	1030x275x530	1160x275x530	1745x275x530	1745x275x530
Weight	Net Weight (kg)	14.5	17.5	18.5	31	32
	Gross Weight (kg)	16.5	19.5	21.5	36	38
	Liquid Side (mm)	6.35(1/4")	6.35(1/4")	9.52(3/8")	9.52(3/8")	9.52(3/8")
Piping Dia	Gas Side (mm)	12.7(1/2")	12.7(1/2")	15.88(5/8")	19.05(3/4")	19.05(3/4")
	Drainage Pipe (mm)	DN20	DN20	DN20	DN20	DN20
Stuffing Quantity	20/40/40HQ	210/450/498	176/368/414	170/362/406	100/211/233	100/211/233

Remark: The above designs and specifications might be changed without prior notice for product improvement.

Medium static pressure duct

Model		GD-18HMRT/U	GD-24HMRT/U	GD-36HMRT/U	GD-48HMRST/U	GD-60HMRST/U
Capacity	Cooling (Btu/h)	18000	24000	36000	48000	60000
	Heating (Btu/h)	19800	26400	39600	52800	66000
Power Supply	V/PH/Hz	220-240/1/50	220-240/1/50	220-240/1/50	220-240/1/50	220-240/1/50
	Air Volume (m³/h)	850	1300	1550	2300	2300
Performance	External static pressure (Pa)	50	70	70	70	70
	Noise Level dB(A)	42	42	45	50	50
Refrigerant	Type	R410A	R410A	R410A	R410A	R410A
Unit Size (WxHxD)	Net Dimension (mm)	850x250x745	1055x295x750	1055x295x755	1385x312x830	1385x312x830
	Packing Dimension (mm)	885x290x785	1080x320x785	1080x320x785	1430x365x895	1430x365x895
Weight	Net Weight (kg)	31	42	44	60	60
	Gross Weight (kg)	35	48	50	68	68
	Liquid Side (mm)	6.35(1/4")	9.52(3/8")	9.52(3/8")	9.52(3/8")	9.52(3/8")
Piping Dia	Gas Side (mm)	12.7(1/2")	15.88(5/8")	19.05(3/4")	19.05(3/4")	19.05(3/4")
	Drainage Pipe (mm)	DN20	DN20	DN20	DN20	DN20
Stuffing Quantity	20/40/40HQ	109/234/262	94/206/234	94/206/234	46/110/125	46/110/125

Remark: The above designs and specifications might be changed without prior notice for product improvement.

High static pressure duct

Model		GD-36HTRST/U	GD-48HTRST/U	GD-60HTRST/U
Capacity	Cooling (Btu/h)	36000	48000	60000
	Heating (Btu/h)	39600	52800	66000
Power Supply	V/PH/Hz	220-240/1/50	220-240/1/50	220-240/1/50
	Air Volume (m³/h)	1650	2300	2500
Performance	External static pressure (Pa)	195	195	195
	Noise Level dB(A)	46	50	60
Refrigerant	Type	R410A	R410A	R410A
Unit Size (WxHxD)	Net Dimension (mm)	1010x370x615	1130x415x615	1130x415x615
	Packing Dimension (mm)	1083x430x679	1185x475x679	1185x475x679
Weight	Net Weight (kg)	51	61	61
	Gross Weight (kg)	57	67	67
	Liquid Side (mm)	9.52(3/8")	9.52(3/8")	9.52(3/8")
Piping Dia	Gas Side (mm)	19.05(3/4")	19.05(3/4")	19.05(3/4")
	Drainage Pipe (mm)	DN20	DN20	DN20
Stuffing Quantity	20/40/40HQ	83/173/206	62/148/148	62/148/148

Remark: The above designs and specifications might be changed without prior notice for product improvement.

R410A DC Inverter Unitary

How to read the models



1. R410A ON/OFF Unitary

2. R410A DC Inverter Unitary

3. R410A DC Inverter VRF

4. R410A Air-cooled Chiller and Terminal

5. R410A Heat Pump Water Heater

Indoor Unit

G W - 36 H R S / V

① | ② | ③ | ④ | ⑤ | ⑥ | ⑦

- ①..... Galanz
- ②..... Universal DC Inverter Outdoor Unit
- ③..... Nominal Capacity(36,000Btu/h)
- ④..... Function Code
C:Cooling Only
H:Heat Pump E:Auxiliary Heater
- ⑤..... R410A
- ⑥..... Power Supply
S:380V 3PH 50HZ /:220V 1PH 50HZ
- ⑦..... DC Inverter Type

Outdoor Unit

G D - 36 H M R S T / V U

① | ② | ③ | ④ | ⑤ | ⑥ | ⑦ | ⑧ | ⑨ | ⑩ | ⑪

- ①..... Galanz
- ②..... Indoor Unit Type
C:Cassette D:Duct Type
U:Ceiling floor
- ③..... Nominal Capacity(36,000Btu/h)
- ④..... Function Code
C:Cooling Only
H:Heat Pump E:Auxiliary Heater
- ⑤..... Static Code
/ :Low Static Pressure
M:Medium Static Pressure T:High Static Pressure
- ⑥..... R410A
- ⑦..... Power Supply
/ :220~240V 1PH 50Hz S:380V 3PH 50Hz
- ⑧..... Indoor Unit
- ⑨..... DC Inverter Type
- ⑩..... A:Automatic Air Swing H:Manual Air Swing
- ⑪..... Matchable with Universal Condensing Unit

R410A DC Inverter Unitary Universal Outdoor Series



12,000 Btu/h



18,000 Btu/h



24,000 Btu/h



36,000 Btu/h



48,000 Btu/h



60,000 Btu/h



Specification

Model		GW-12HR/V	GW-18HR/V	GW-24HR/V	GW-36HRS/V	GW-48HRS/V	GW-60HRS/V
Capacity	Cooling (Btu/h)	12000	18000	24000	36000	48000	60000
	Heating (Btu/h)	13200	19800	26400	39600	52800	66000
Power Supply	V/PH/Hz	220-240/1/50	220-240/1/50	220-240/1/50	380/3/50	380/3/50	380/3/50
Performance	Air Volume (m ³ /h)	1500	2100	2800	3800	5000	5800
	Noise Level dB(A)	53	56	58	59	62	63
Refrigerant	Type	R410A/1.07	R410A/1.4	R410A/2.2	R410A/2.7	R410A/3.1	R410A/5.3
Unit Size (WxHxD)	Net Dimension (mm)	770x520x280	845x680x310	880x790x360	970x928x345	973x1239x350	973x1239x350
	Packing Dimension (mm)	910x630x380	1010x765x430	1030x890x480	1095x1070x470	1065x1390x435	1065x1390x435
Weight	Net Weight (kg)	37	64	70	91	106	109
	Gross Weight (kg)	40.5	69	80	102	115	117
Piping Dia	Liquid Side (mm)	6.35(1/4")	6.35(1/4")	9.52(3/8")	9.52(3/8")	9.52(3/8")	9.52(3/8")
	Gas Side (mm)	12.7(1/2")	12.7(1/2")	15.88(5/8")	19.05(3/4")	19.05(3/4")	19.05(3/4")
	Drainage Pipe (mm)	25	25	30	30	50	50
Stuffing Quantity	20/40/40HQ	126/258/344	90/186/186	48/100/150	48/100/100	27/56/56	27/56/56

Remark: The above designs and specifications might be changed without prior notice for product improvement.



R410A DC Inverter Unitary Four-way Cassette Indoor Series



Detachable corners enable easy access to control parts when installing and maintaining. One-step panel can be fitted without any tool.

4 way air discharge ensures better air distribution and circulation in the room, with effective blowing height 3.5m

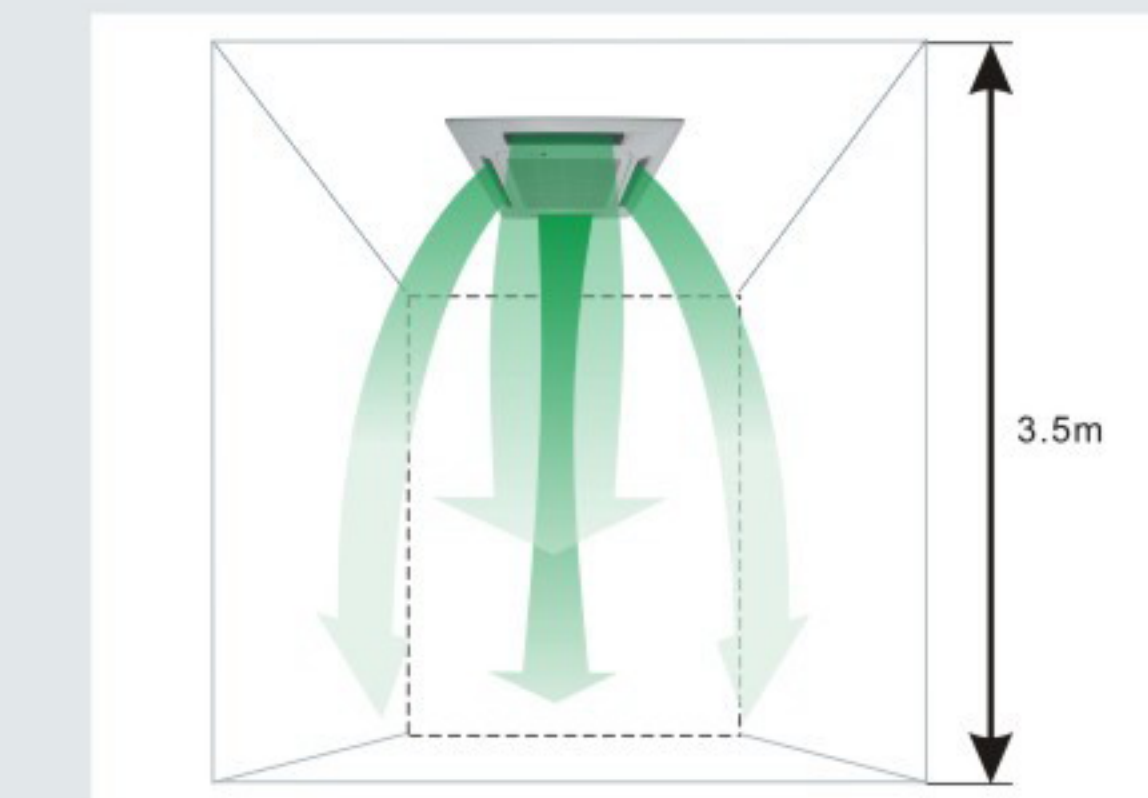
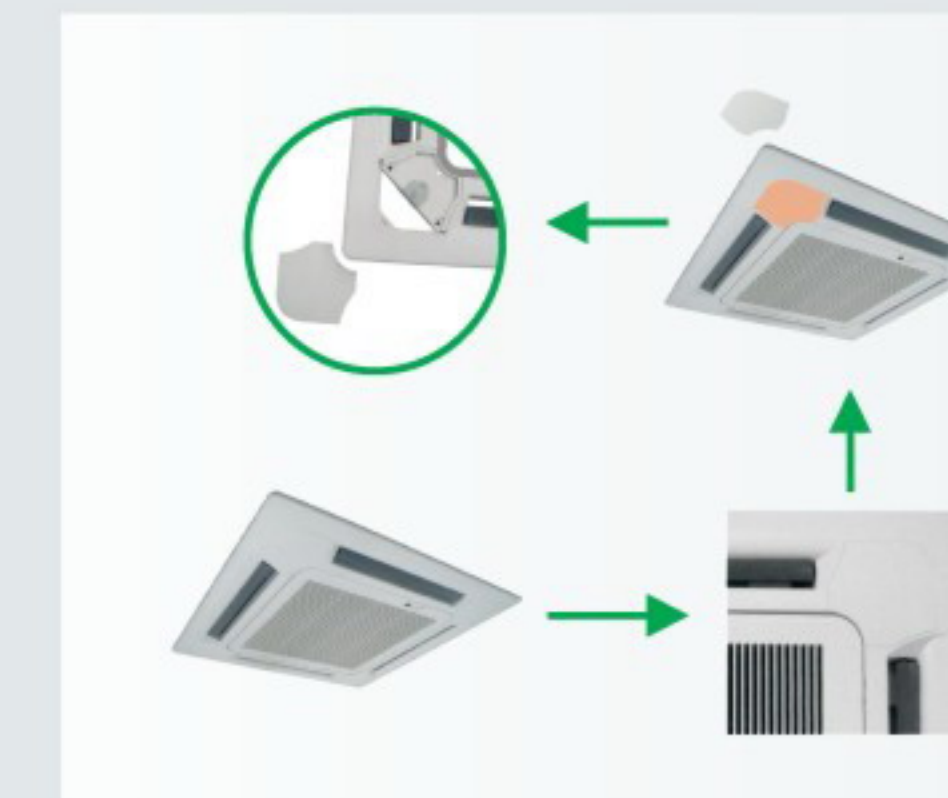

Compact design for 18k type, suitable for easy ceiling installation, no more additional work needed.

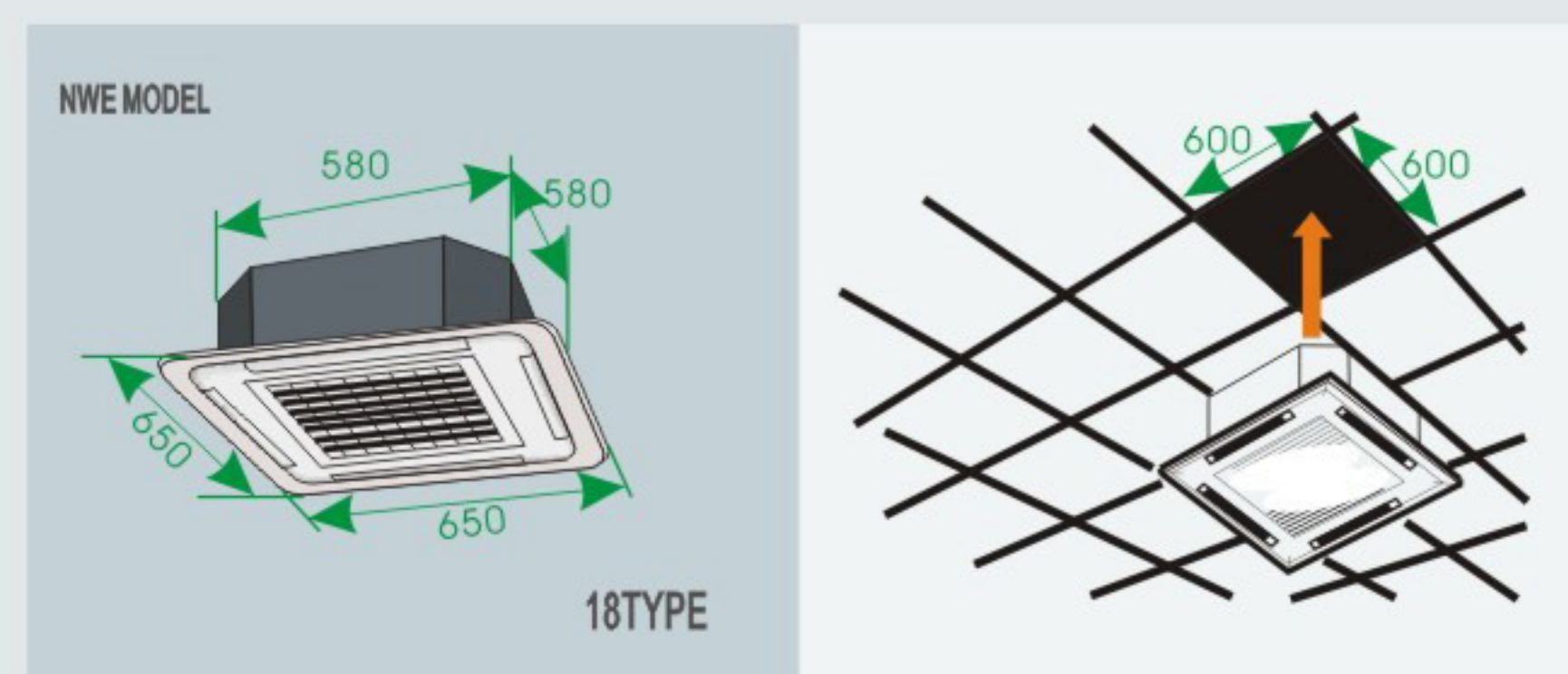

Four stepping motors. One stepping motor for each vane, makes it's moving easier and safer

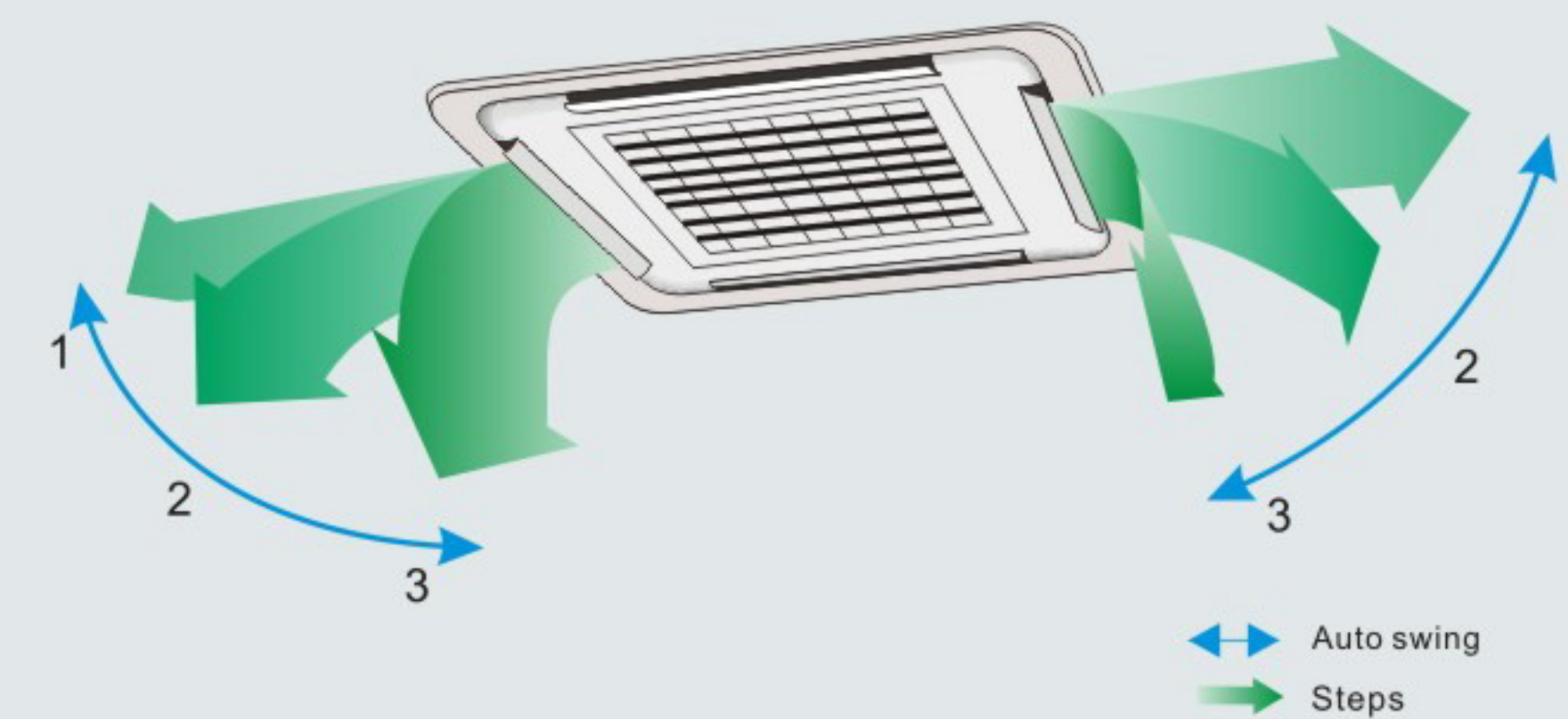

Auto swing and 3 steps of swing positions controlled by controller, standard mode, anti-direct blow mode, anti-ceiling blow mode

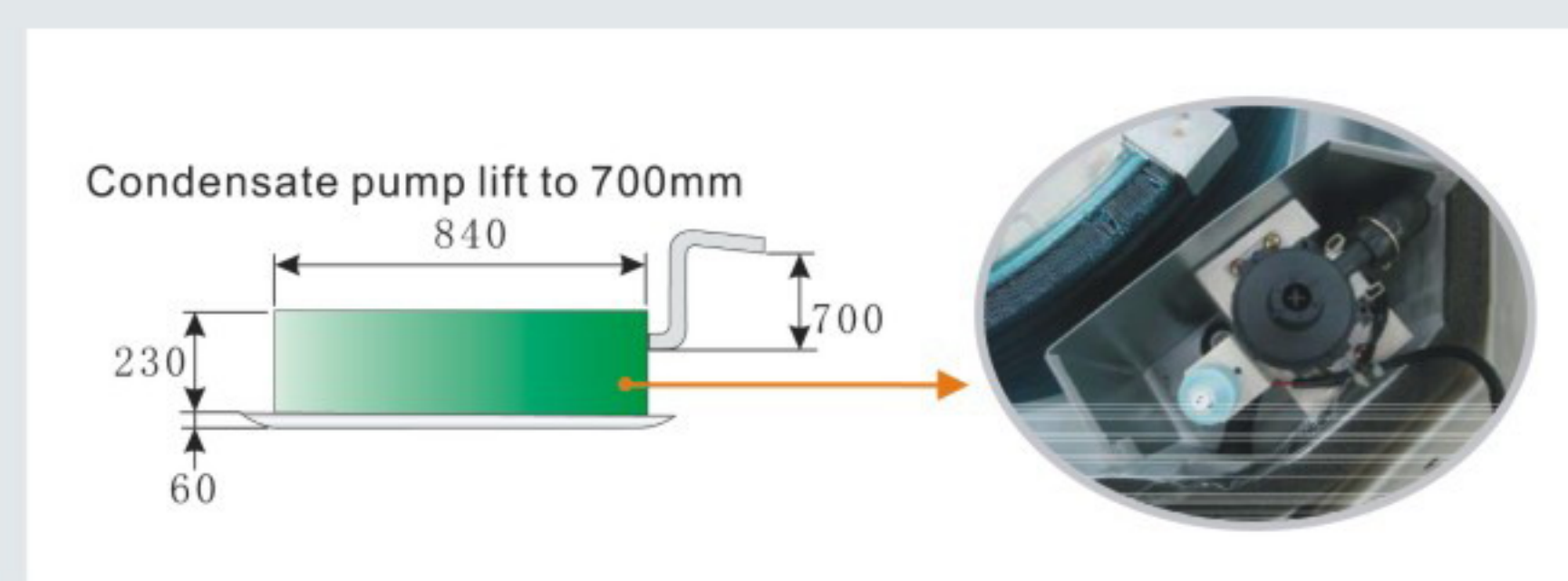

Built-in drain pump, makes the condensing water drainage easier and safer

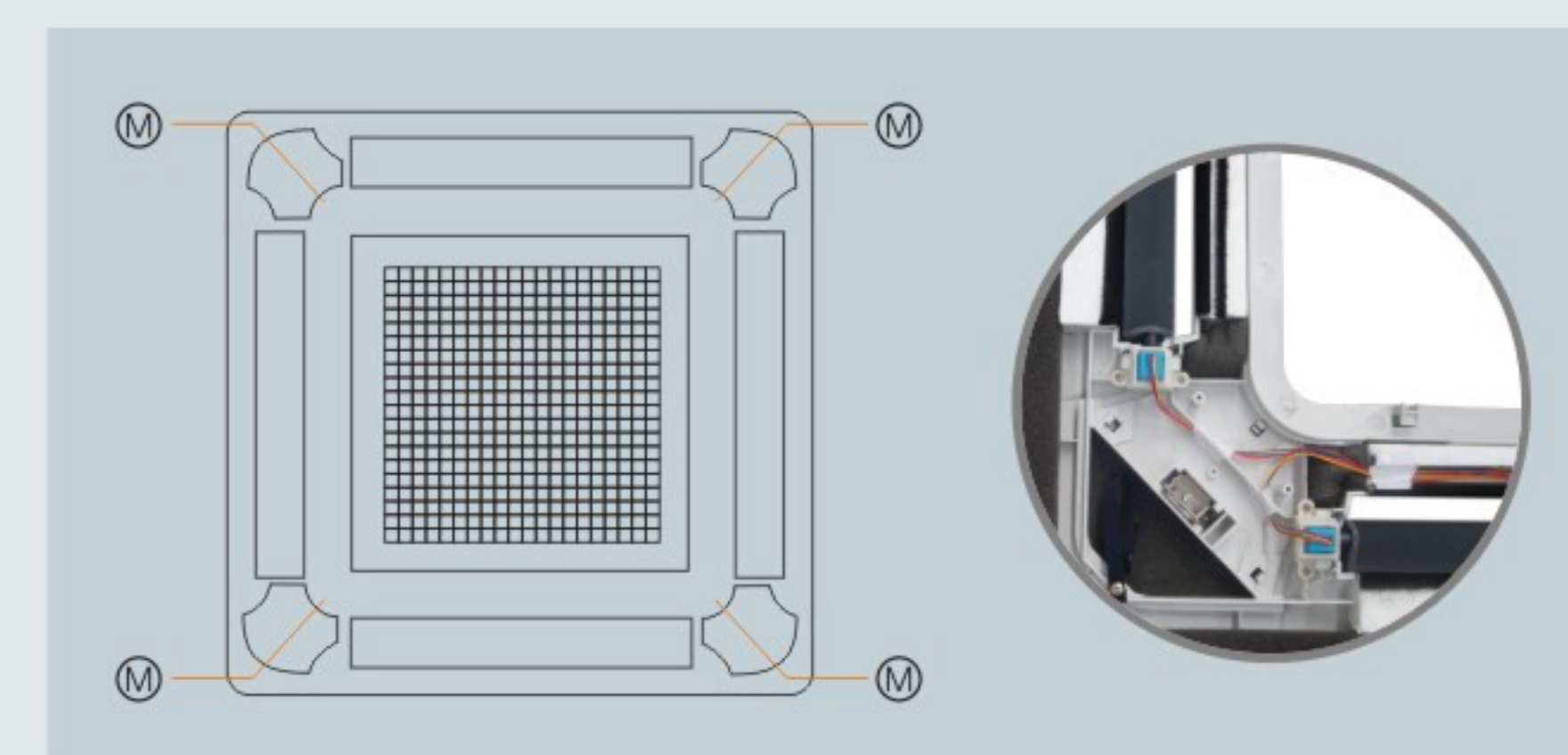

Specification

Model		GC-12HRT/VU	GC-18HRT/VU	GC-24HRT/VU	GC-36HRST/VU	GC-48HRST/VU
Capacity	Cooling (KW)	3.2(1.4-3.9)	5.1(1.6-5.8)	7.0(1.8-8.0)	10.0(5.0-11.4)	14.0(7.0-16.8)
	Heating (KW)	3.5(1.4-4.5)	5.5(1.5-6.3)	7.6(1.5-8.2)	11.4(5.1-12.5)	15.2(6.5-17)
Power Supply	V/PH/Hz	220-240/1/50	220-240/1/50	220-240/1/50	220-240/1/50	220-240/1/50
Performance	Air Volume (m3/h)	500	800	1210	1600	1800
	Noise Level dB(A)	42	42	45	45	52
Perfigerant	Type	R410A	R410A	R410A	R410A	R410A
Unit Size (WxHxD)	Net Dimension (mm)	570x255x570	570x255x570	840x230x840	840x305x840	840x305x840
	Packing Dimension (mm)	710x310x710	710x310x710	950x345x940	950x415x940	950x415x940
Panel Size (WxHxD)	Net Dimension (mm)	650x30x650	650x30x650	953x40x953	953x40x953	953x40x953
	Packing Dimension (mm)	760x100x760	760x100x760	1030x135x1030	1030x135x1030	1030x135x1030
Weight	Net Weight(Unit) (kg)	23	23	27	33	35
	Net Weight(Panel) (kg)	2	2	6	6	6
	Gross Weight(Unit) (kg)	25	25	36	43	45
	Gross Weight(Panel) (kg)	4	4	9	9	9
Piping Dia	Liquid Side (mm)	6.35(1/4")	6.35(1/4")	9.52(3/8")	9.52(3/8")	9.52(3/8")
	Gas Side (mm)	12.7(1/2")	12.7(1/2")	15.88(5/8")	19.05(3/4")	19.05(3/4")
	Drainage Pipe (mm)	32	32	32	32	32
Stuffing Quantity	20/40/40HQ	126/288/306	126/288/306	47/118/134	43/105/116	43/105/116

Remark: The above designs and specifications might be changed without prior notice for product improvement.

R410A DC Inverter Unitary Ceiling-floor Indoor Series



Manual or automatic control of the air outlet louver available

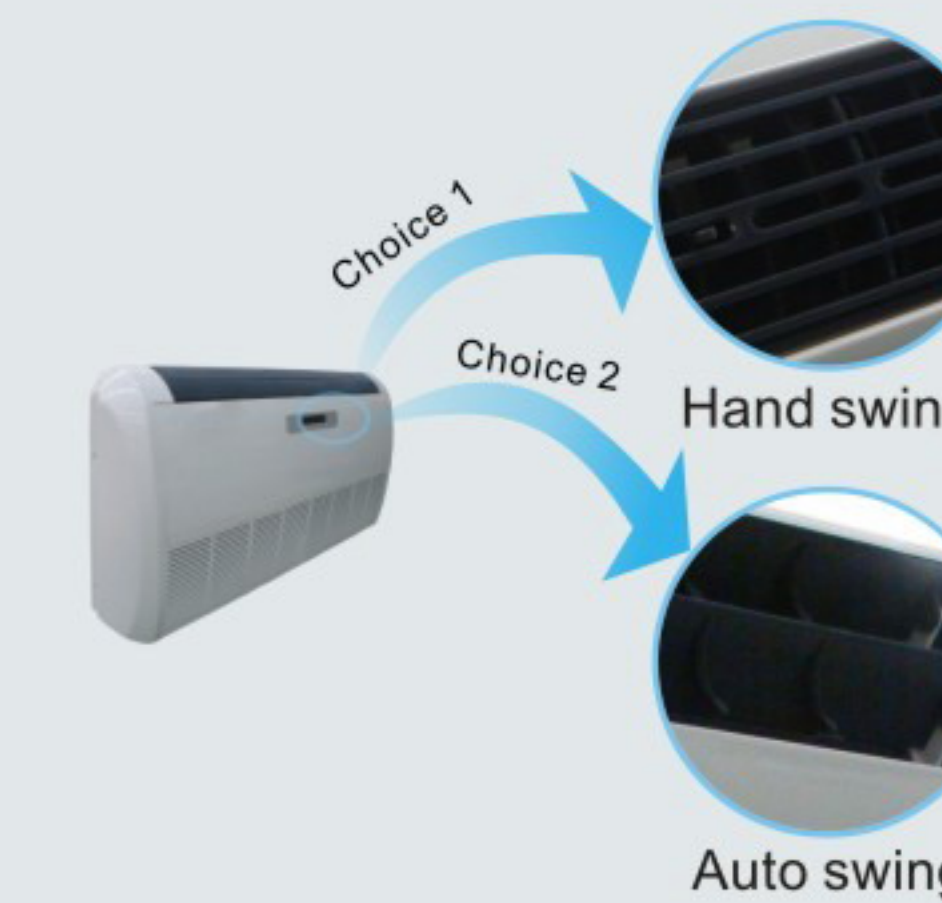

LED digital display

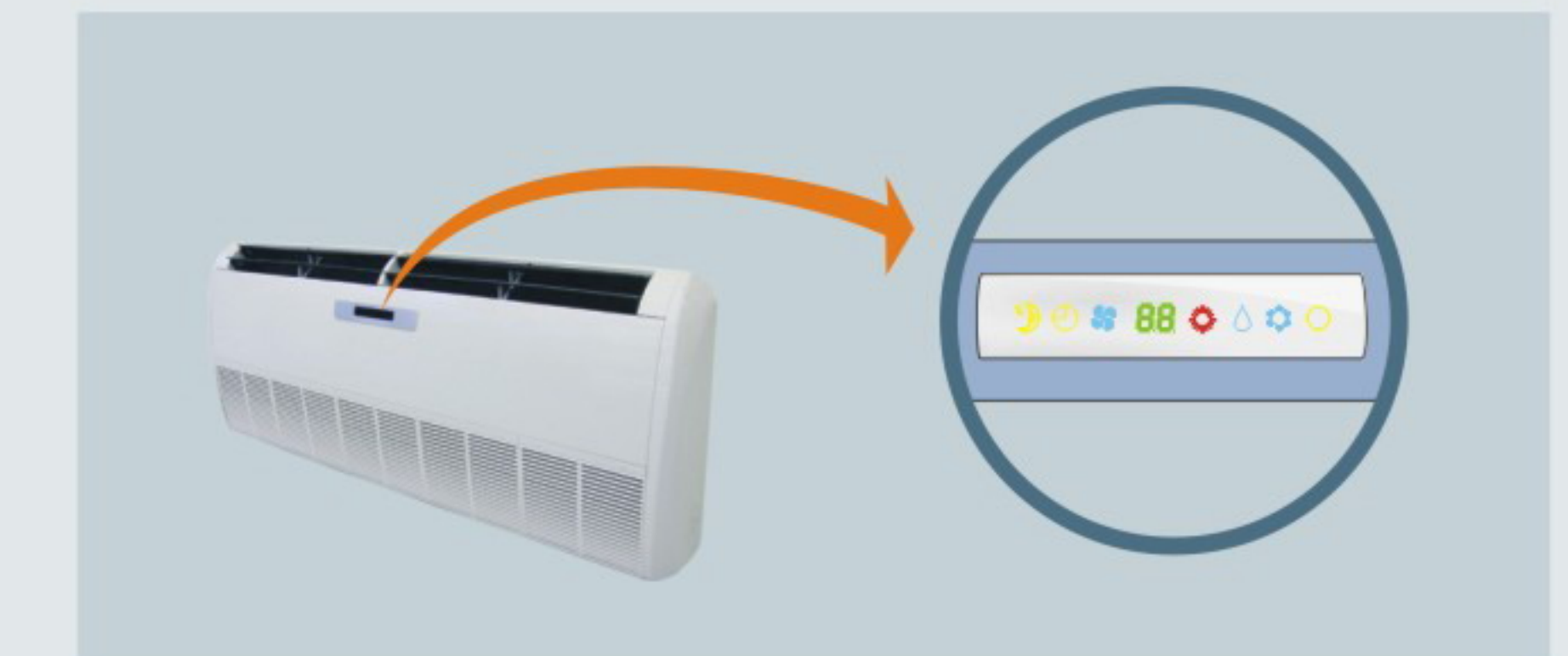

Slim and compact design, four different body sizes

SIZE	A	B	C
12k/18k/24k	1016	776	818
30k/36k	1316	1076	1118
48k	1616	1376	1418
60k	1916	1676	1718

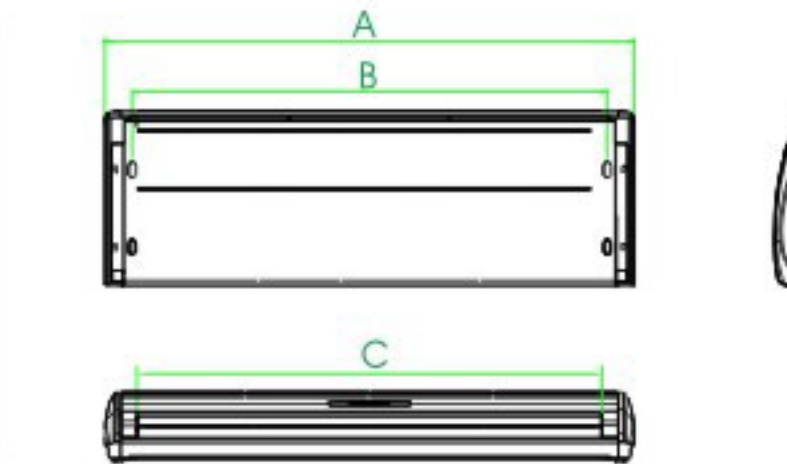

Ceiling and floor installing optional carter for different interior design requirements.

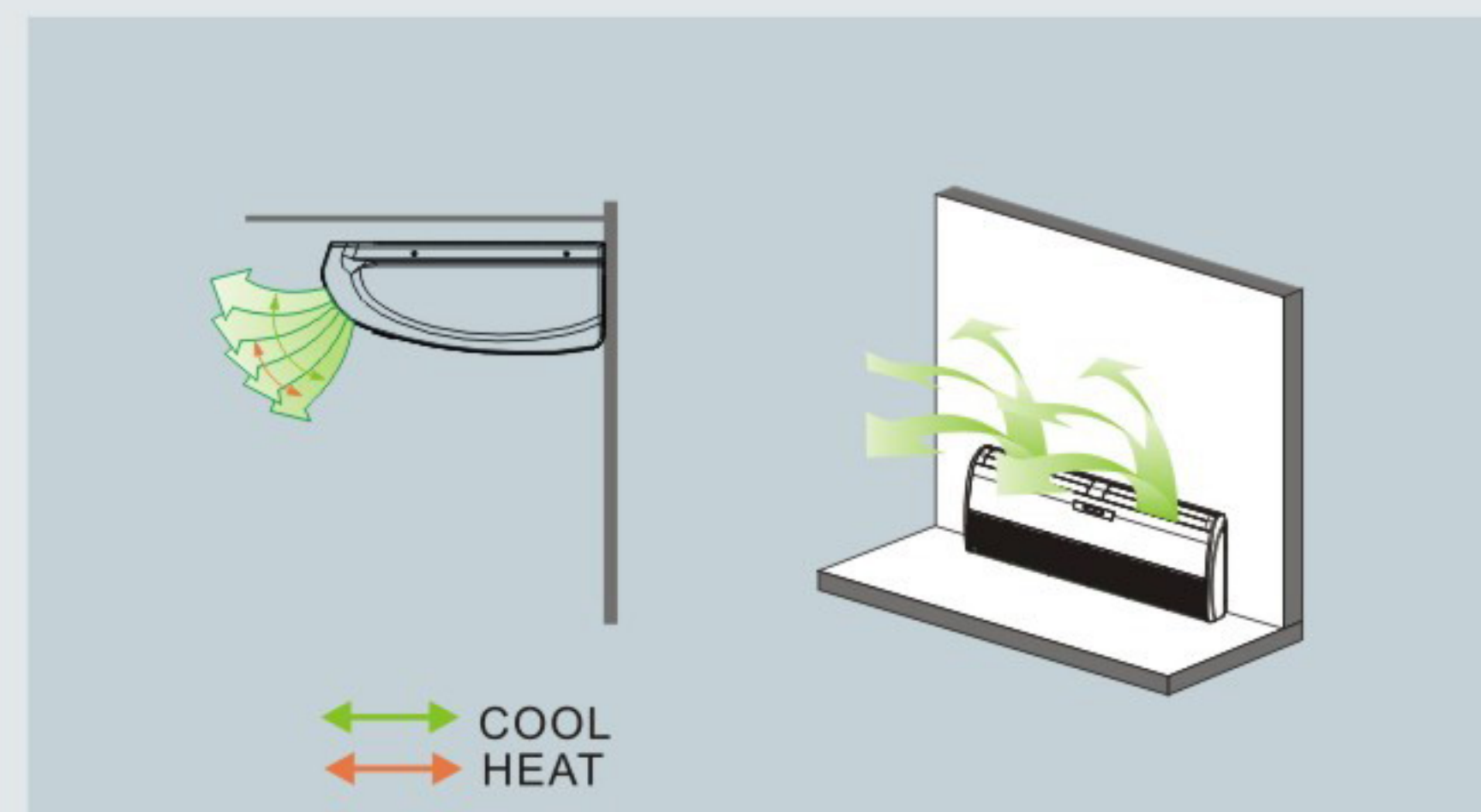

Horizontal and vertical wide-angle swing directions.

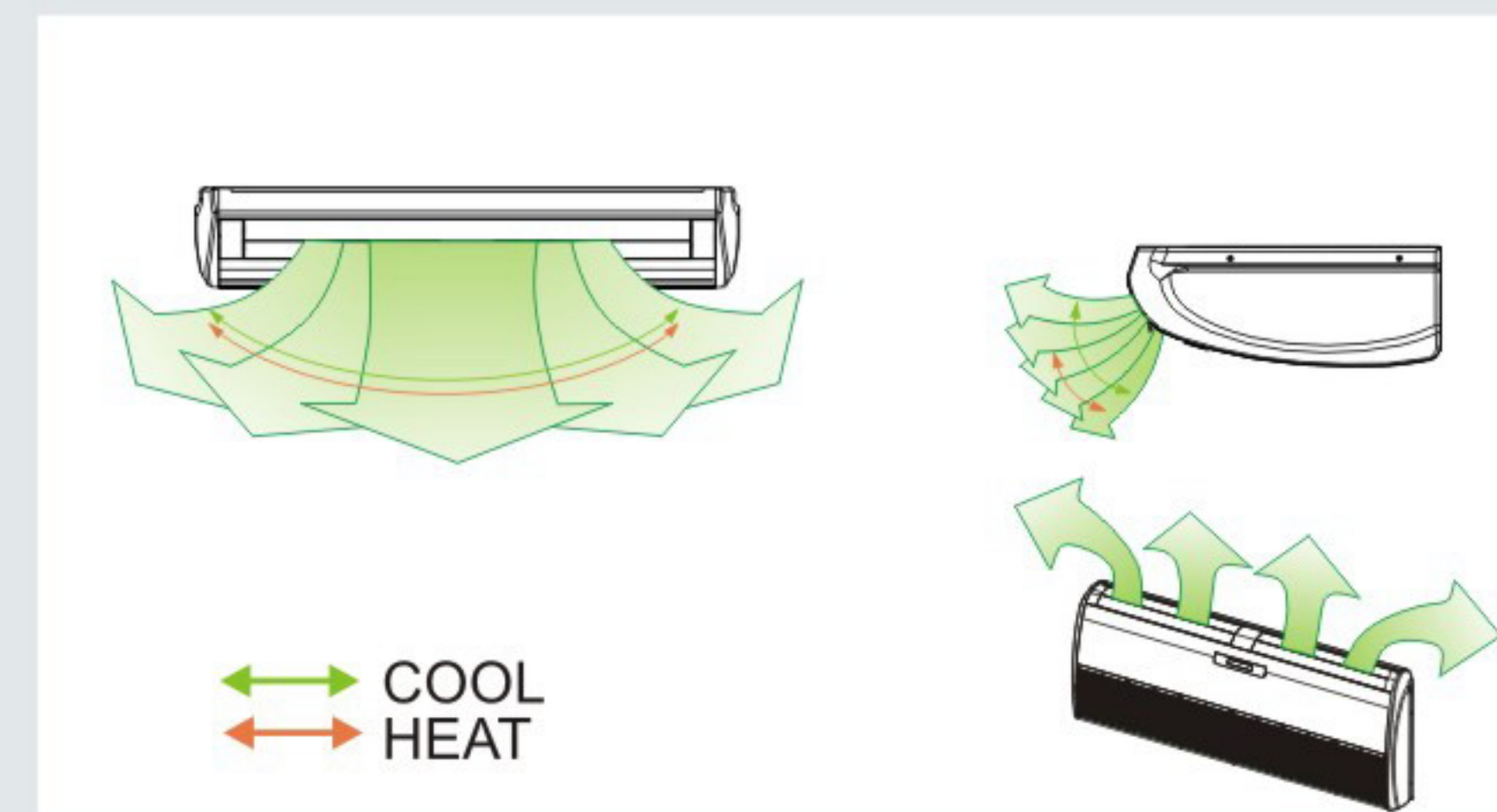

Special side-panel design for control box and pipe connection makes installation and maintenance more convenient.

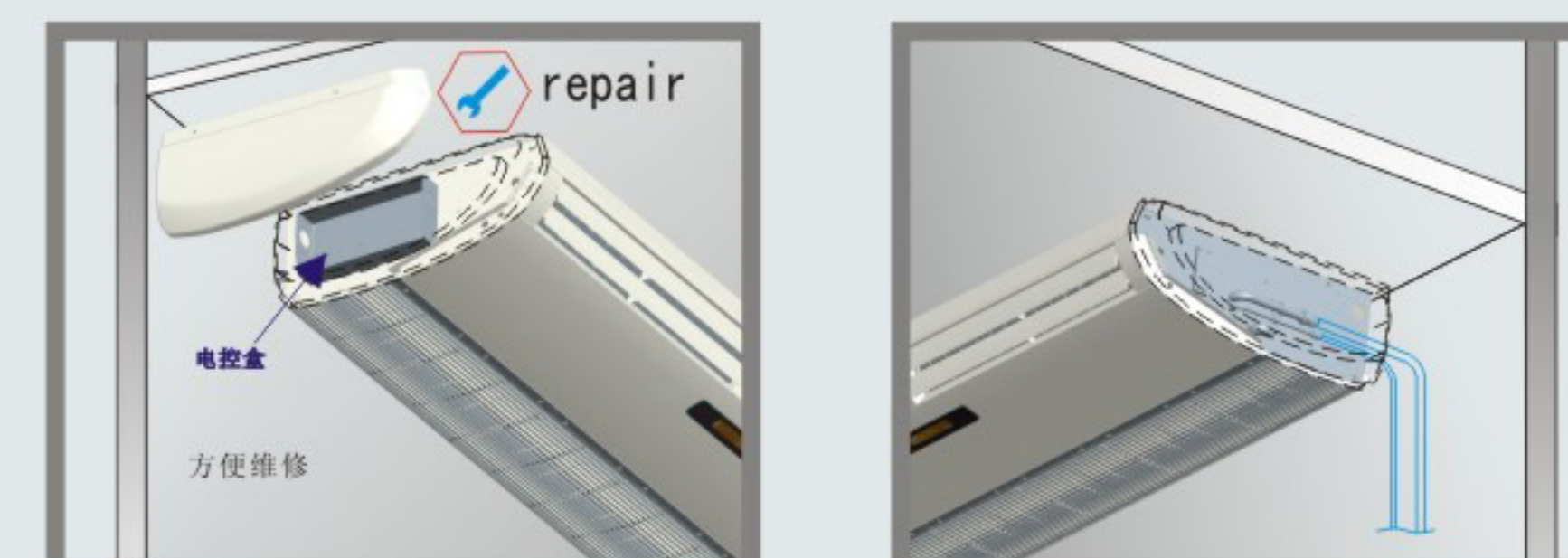

Easy accessible filter when cleaning

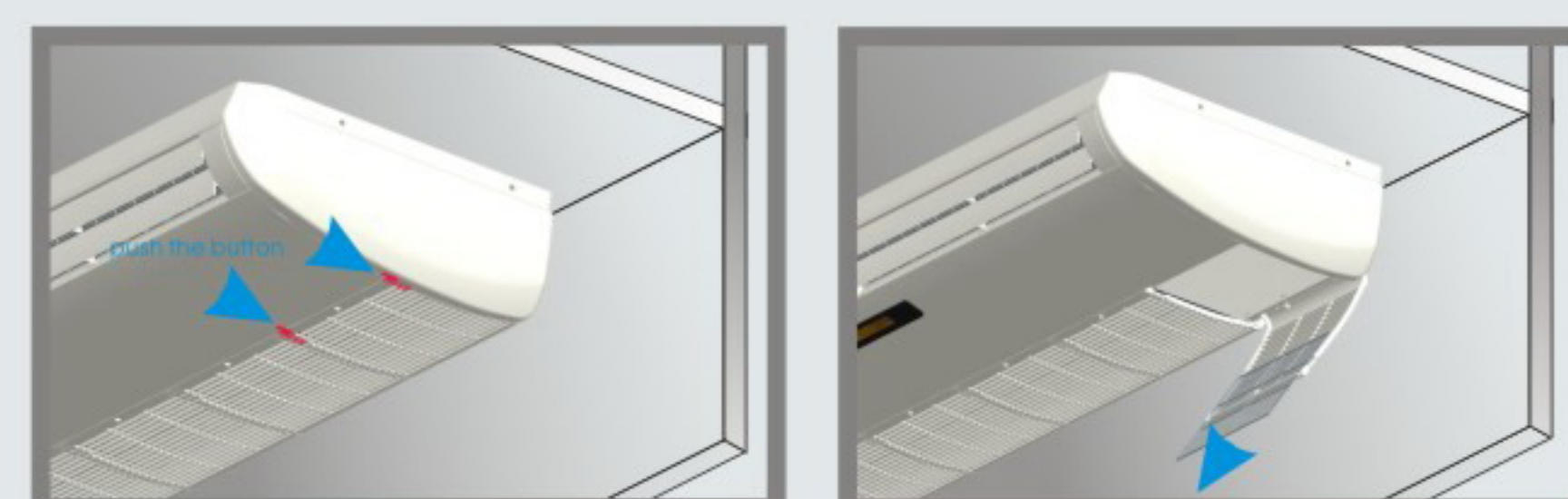

Specification

Model		GU-12HRT/VAU GU-12HRT/VHU	GU-18HRT/VAU GU-18HRT/VHU	GU-24HRT/VAU GU-24HRT/VHU	GU-36HRST/VAU GU-36HRST/VHU	GU-48HRST/VAU GU-48HRST/VHU	GU-60HRST/VAU GU-60HRST/VHU
Capacity	Cooling (KW)	3.2(1.4-3.9)	5.1(1.6-6.0)	7.0(1.8-8.0)	10.0(5.0-11.4)	14.0(7.0-16.8)	17.0(8.0-19)
	Heating (KW)	3.5(1.5-4.5)	5.5(1.5-6.3)	7.7(1.8-8.2)	11.4(5.1-12.5)	15.2(6.5-17)	18.0(8.0-20)
Power Supply	V/PH/Hz	220-240/1/50	220-240/1/50	220-240/1/50	220-240/1/50	220-240/1/50	220-240/1/50
Performance	Air Volume (m³/h)	600	890	1100	1300	2000	2200
	Noise Level dB(A)	42	44	46	48	49	52
Refrigerant	Type	R410A	R410A	R410A	R410A	R410A	R410A
Unit Size (WxHxD)	Net Dimension (mm)	1016x240x630	1016x240x630	1016x240x630	1316x240x630	1616x240x630	1916x240x630
	Packing Dimension (mm)	1085x280x700	1085x280x700	1085x280x700	1385x280x700	1685x280x700	1985x280x700
Weight	Net Weight (kg)	32	34	34	45	56	70
	Gross Weight (kg)	37	39	39	50	62	78
Piping Dia	Liquid Side (mm)	6.35(1/4")	6.35(1/4")	9.52(3/8")	9.52(3/8")	9.52(3/8")	9.52(3/8")
	Gas Side (mm)	12.7(1/2")	12.7(1/2")	15.88(5/8")	19.05(3/4")	19.05(3/4")	19.05(3/4")
	Drainage Pipe (mm)	Φ19.05	Φ19.05	Φ19.05	Φ19.05	Φ19.05	Φ19.05
Stuffing Quantity	20/40/40HQ	142/298/332	142/298/332	142/298/332	111/226/251	91/189/210	77/162/180

Remark: The above designs and specifications might be changed without prior notice for product improvement.

R410A DC Inverter Unitary Duct Type Indoor Series



(Optional)



Wide range of applications. suitable for places such as restaurants, concert halls and hotels.



Two air intake methods: air intake from below or from rear.

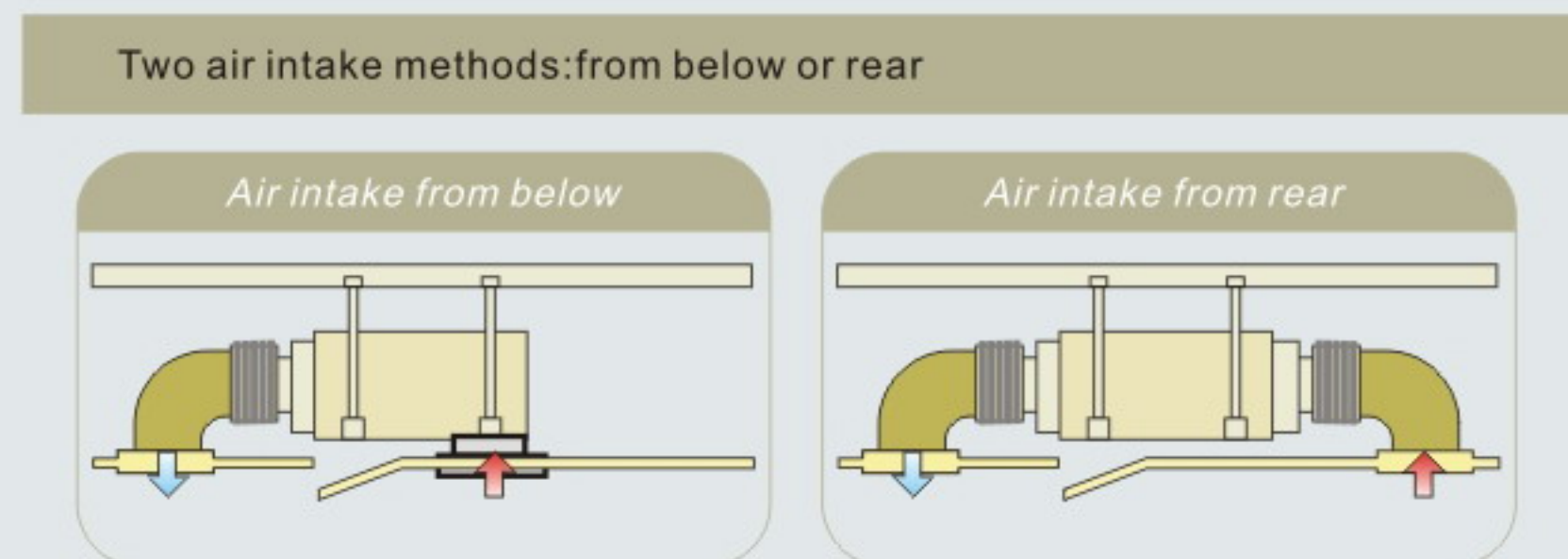

Special design of drain pan to prevent leakage of drain water

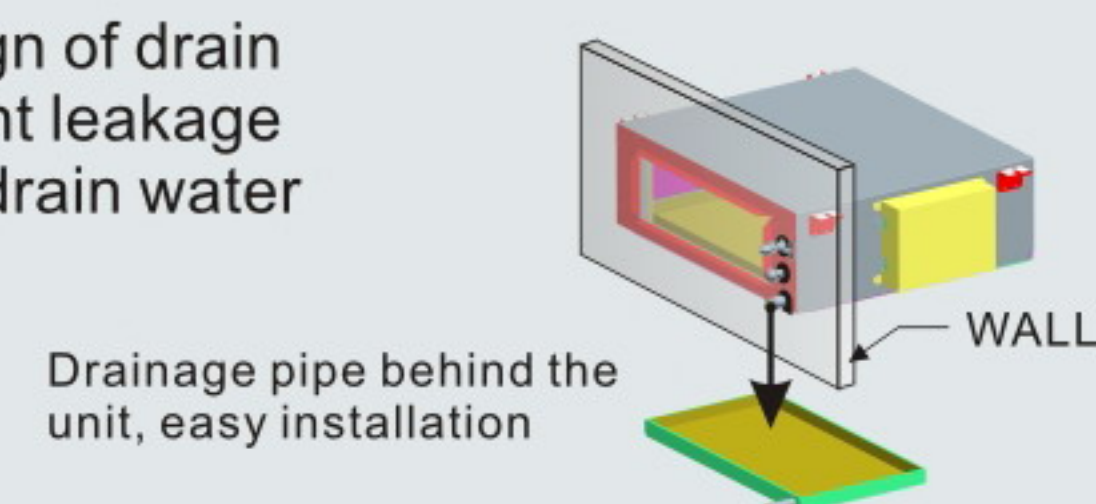

Drainage pipe behind the unit, easy installation

Three fan speeds available

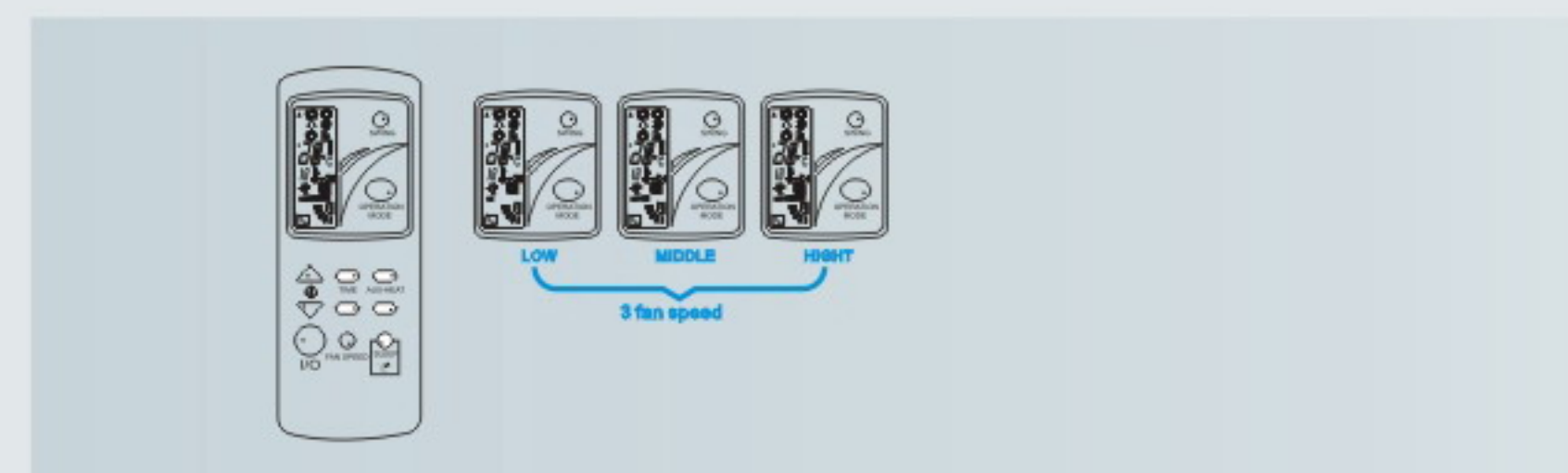

Specification

Model		GD-12HRT/VU	GD-18HMRT/VU	GD-24HMRT/VU	GD-36HMRT/VU	GD-48HMRST/VU	GD-60HMRST/VU
Capacity	Cooling (KW)	3.2(1.4-3.9)	5.2(1.6-6.1)	7.0(1.8-8.0)	10.0(5.0-11.4)	14.0(7.0-16.8)	17.0(8.0-19)
	Heating (KW)	3.5(1.3-4.5)	5.6(1.5-6.3)	7.7(1.5-8.2)	11(5.1-12.5)	15.2(6.5-17)	18.0(8.0-20)
Power Supply	V/PH/Hz	220-240/1/50	220-240/1/50	220-240/1/50	220-240/1/50	220-240/1/50	220-240/1/50
Performance	Air Volume (m ³ /h)	550	780	1300	1550	2300	2300
	External static pressure (Pa)	30	50	70	70	70	70
	Noise Level dB(A)	40	42	42	45	50	50
Refrigerant	Type	R410A	R410A	R410A	R410A	R410A	R410A
Unit Size (WxHxD)	Net Dimension (mm)	815x240x490	920x250x675	1055x295x750	1055x295x755	1385x312x830	1385x312x830
	Packing Dimension (mm)	845x275x530	950x275x695	1080x320x785	1080x320x785	1430x365x895	1430x365x895
Weight	Net Weight (kg)	14.5	26	42	44	60	60
	Gross Weight (kg)	17.5	30	48	50	68	68
Piping Dia	Liquid Side (mm)	6.35(1/4")	6.35(1/4")	9.52(3/8")	9.52(3/8")	9.52(3/8")	9.52(3/8")
	Gas Side (mm)	12.7(1/2")	12.7(1/2")	15.88(5/8")	19.05(3/4")	19.05(3/4")	19.05(3/4")
	Drainage Pipe (mm)	DN20	DN20	DN20	DN20	DN20	DN20
Stuffing Quantity	20/40/40HQ	210/450/498	109/234/262	94/206/234	94/206/234	55/117/129	62/148/148

Remark: The above designs and specifications might be changed without prior notice for product improvement.



R410A DC Inverter VRF How to read the models

VRF Outdoor Unit

DLR - V 280 W / S A - M

- ①..... VRF
- ②..... Function Code
R:Heat pump / :Cooling Only
- ③..... System Type
V:DC Inverter D:Digital Scroll
- ④..... Capacity(28kw)
- ⑤..... Outdoor Unit
- ⑥..... Power Supply
S:380V 50HZ 3PH / :220V 50HZ 1PH
- ⑦..... R410A
- ⑧..... Modular Design

VRF Indoor Unit

DLR - V 56 Q4 A

- ①..... VRF
- ②..... Function Code
R:Heat pump / :Cooling Only
- ③..... System Type
V:DC Inverter D:Digital Scroll
- ④..... Capacity(5.6kw)
- ⑤..... Indoor Unit Type
Q4:4-Way Cassette LD:Ceiling Floor
G:Wall Mounted T1:High Static Duct
T2:Medium Static Duct T3:Low Static Duct
- ⑥..... R410A

1. R410A ON/OFF Unitary

2. R410A DC Inverter Unitary

3. R410A DC Inverter VRF

4. R410A Air-cooled Chiller and Terminal

5. R410A Heat Pump Water Heater

R410A DC Inverter VRF

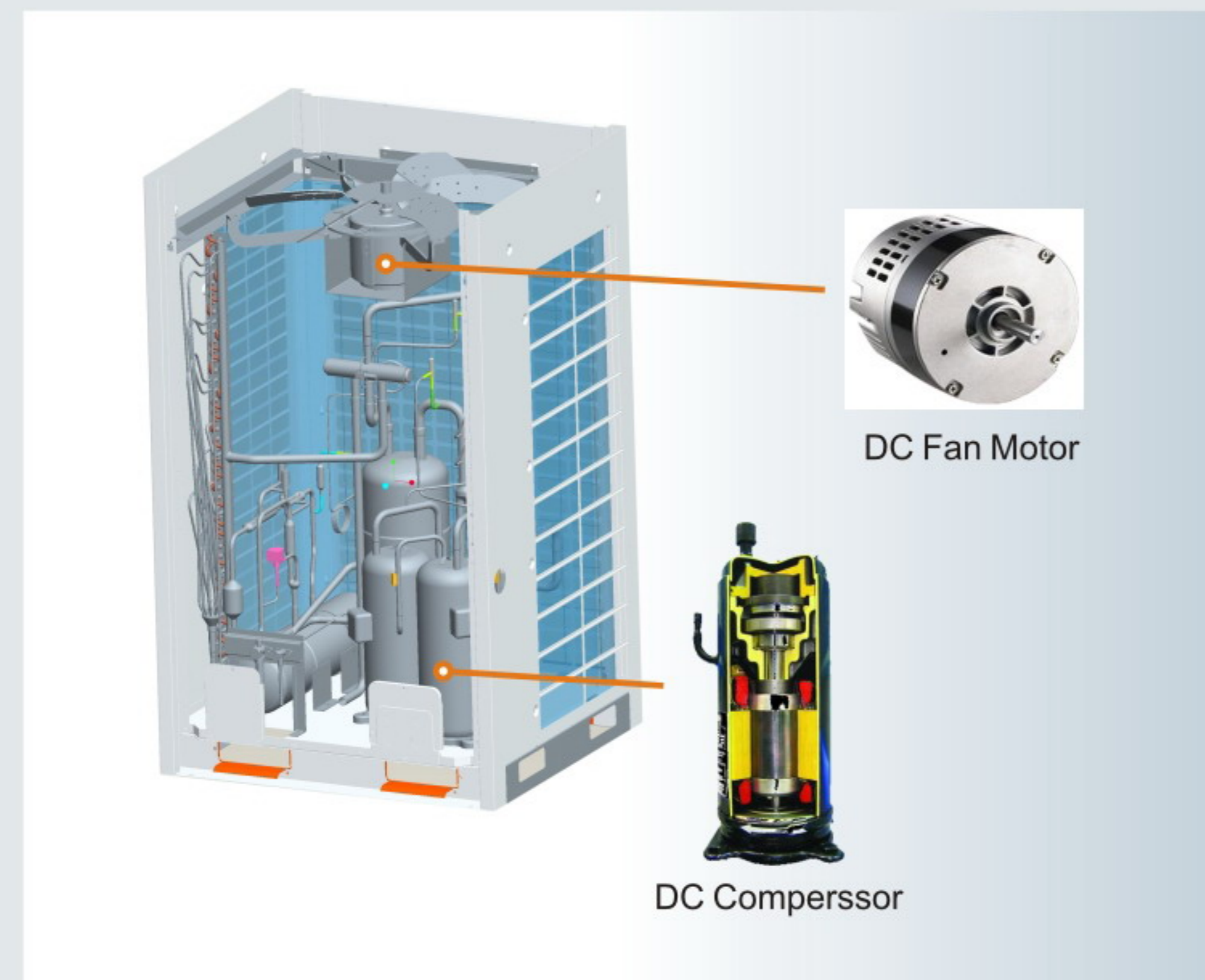

Diversified indoor types, suitable for various indoor installations. One outdoor can drive many indoors, less space requirement for outdoor unit.

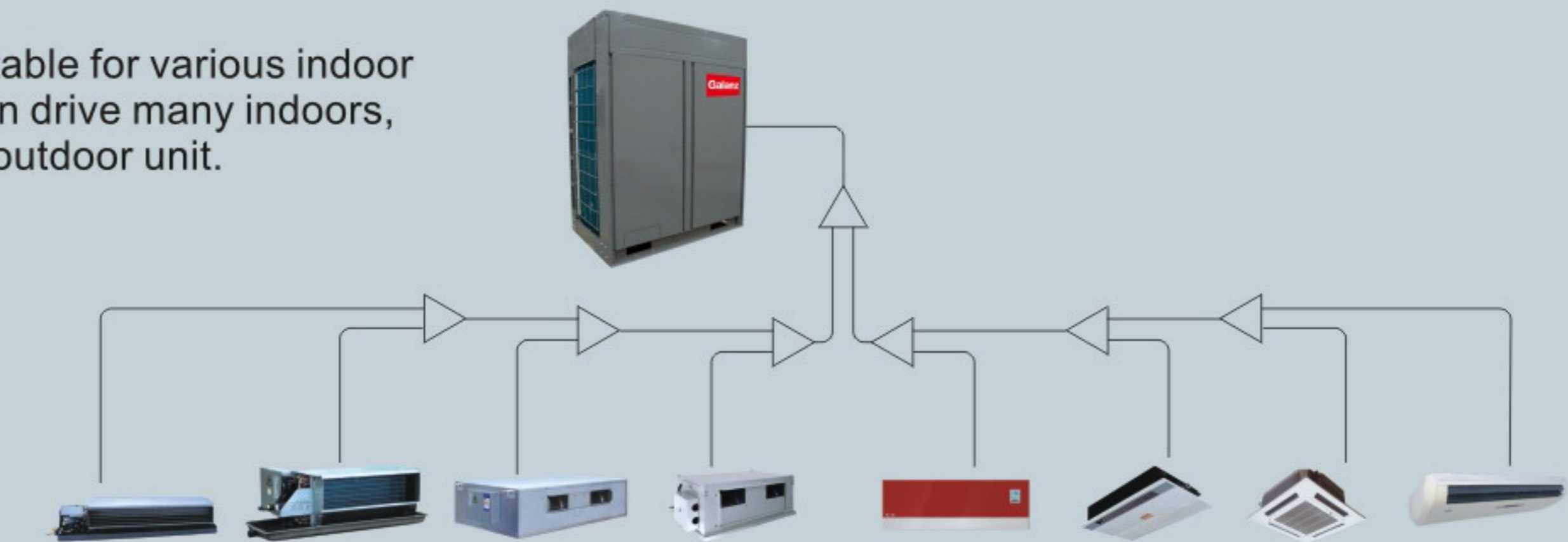

Notes: Outdoor unit installed above

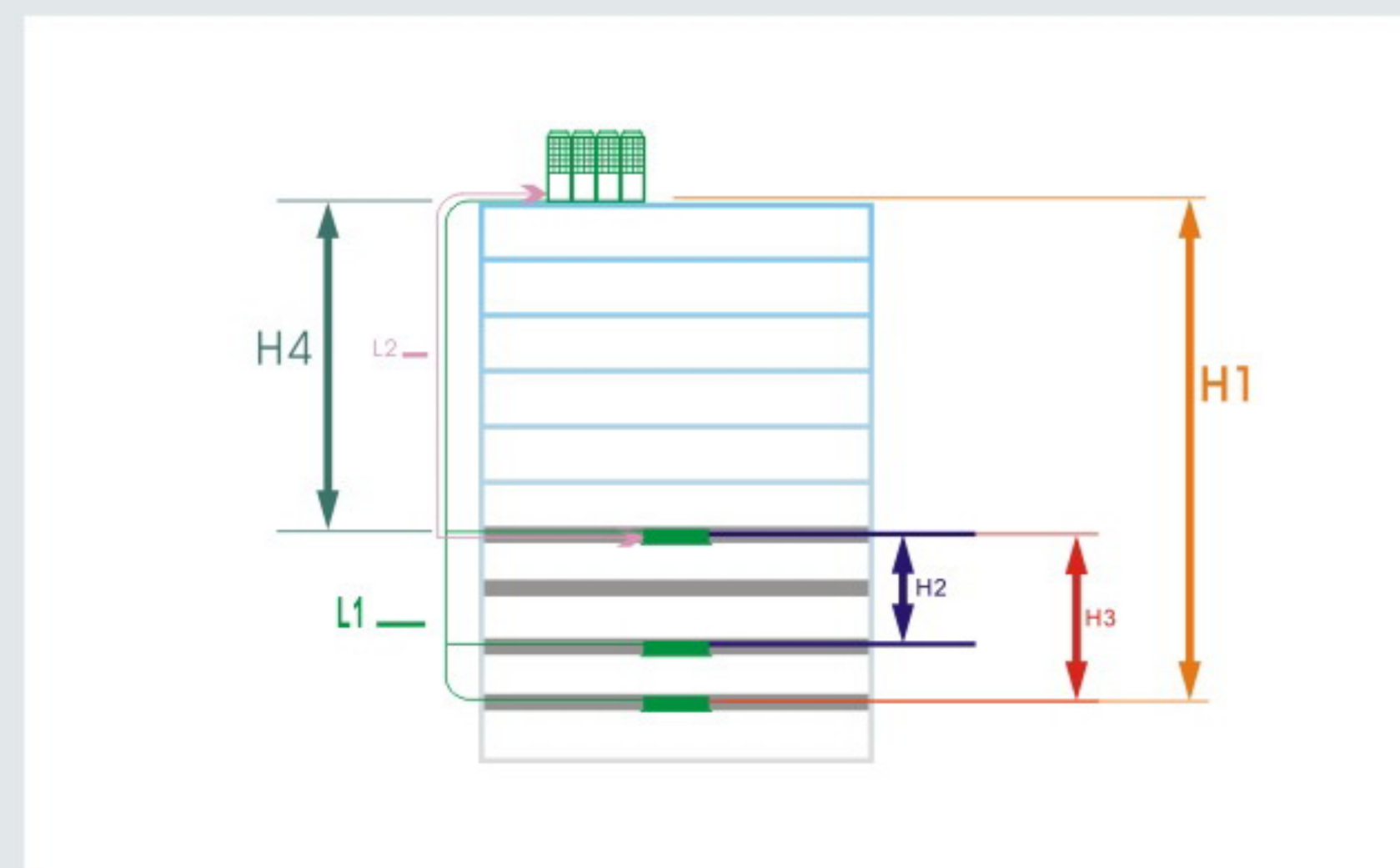

L1: 150m max. pipe length between indoor and outdoor
 H1: 50m max. height difference between indoor and outdoor
 H2: 15m max. height difference between indoors

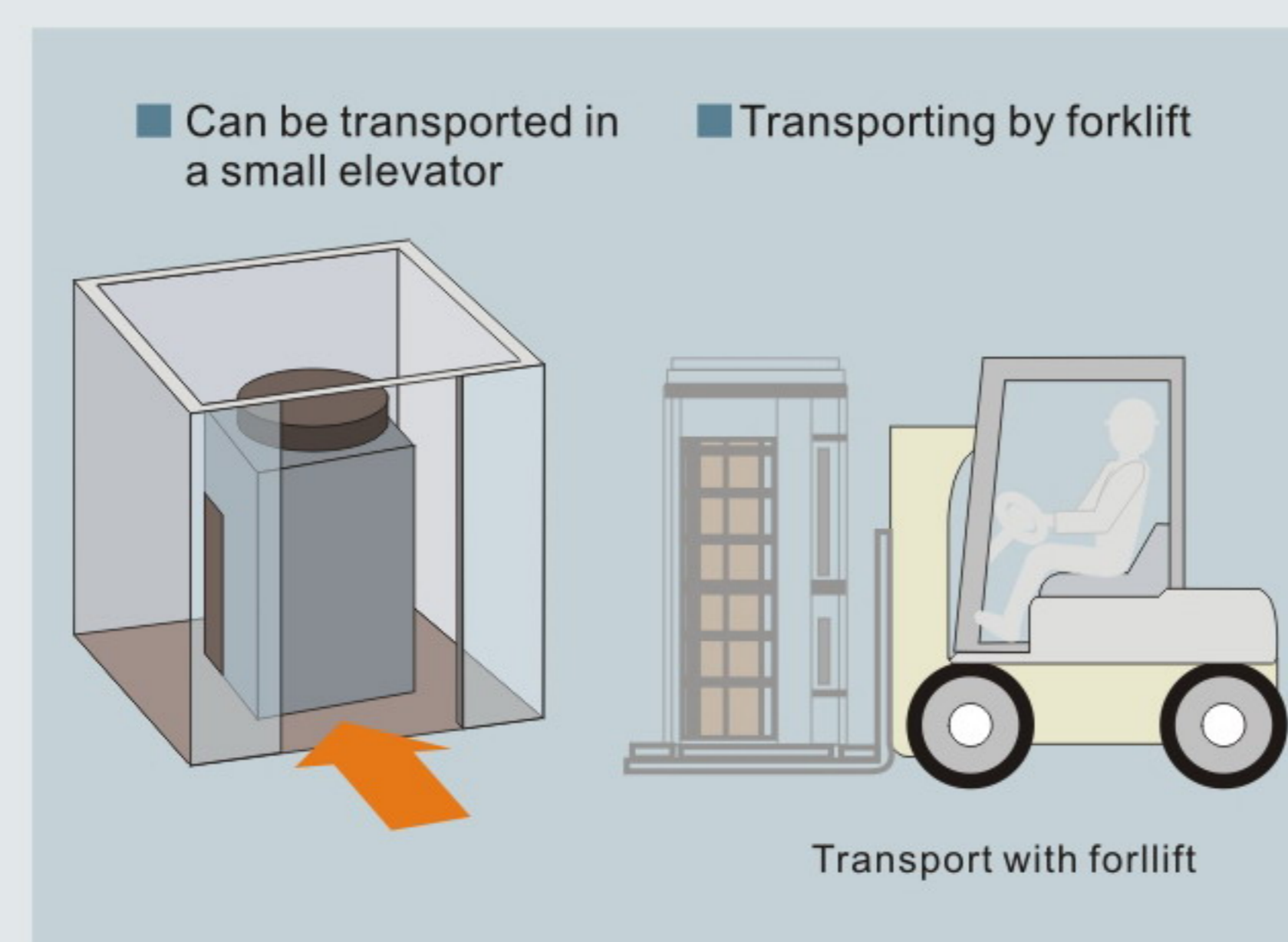

Easy transportation:
 The outdoor unit can be transported in a small elevator

Parameters		Model	DLR-V255W/SA-M	DLR-V280W/SA-M	DLR-V335W/SA-M	DLR-V400W/SA-M	DLR-V450W/SA-M
Cooling capacity	kw		25.5	28	33.5	40	45
Heating capacity	kw		28	30	37.5	45	50
Cooling power input	kw		8.6	9.5	11.4	13.3	15.2
Heating power input	kw		7.8	8.9	10.3	12.4	13.9
Cooling current	A		13.7	15.1	18.2	21.3	24.3
Heating current	A		12.4	14.2	16.5	19.8	22.2
Refrigerant	Type		R410A	R410A	R410A	R410A	R410A
	Charge volume	kg	10	10	10	13	13.0
Connected pipes	Liquid pipe (Φ)	mm	12.7	12.7	12.7	15.88	15.88
	Gas pipe (Φ)	mm	25	25	25	28.6	28.6
Power supply			380V/50Hz	380V/50Hz	380V/50Hz	380V/50Hz	380V/50Hz
Dimensions(WxDxH)	mm		1290x785x1610	1290x785x1610	1290x785x1610	1290x785x1610	1290x785x1610
Noise level	dB(A)		60	60	60	62	61
Weight	kg		325	325	325	325	390

Remark: The above designs and specifications might be changed without prior notice for product improvement.

R410A DC Inverter VRF

Four-way Casstte Indoor Series



SPECIFICATIONS

Parameters		Model	DLR-V28Q4A	DLR-V36Q4A	DLR-V45Q4A	DLR-V56Q4A	DLR-V71Q4A
Cooling capacity	kw		2.8	3.6	4.5	5.6	7.1
Heating capacity	kw		3.2	4.0	5.6	6.3	8.0
Air flow volume	m ³ /h		750	750	850	850	1200
External static pressure	Pa		0	0	0	0	0
Motor power input	KW		0.08	0.08	0.08	0.08	0.10
Power supply			220V 1N~/50Hz	220V 1N~/50Hz	220V 1N~/50Hz	220V 1N~/50Hz	220V 1N~/50Hz
Connected pipe size	Liquid pipe (Φ)	mm	9.52	9.52	9.52	9.52	9.52
	Gas pipe (Φ)	mm	15.88	15.88	15.88	15.88	15.88
	Drainage pipe	mm	DN32	DN32	DN32	DN32	DN32
Noise level	dB(A)		36	36	37	37	37
Weight	kg		27	27	27	257	27
Dimensions(WxDxH)	mm		840x230x840	840x230x840	840x230x840	840x230x840	840x230x840
			955x30x955	955x30x955	955x30x955	955x30x955	955x30x955

Remark: The above designs and specifications might be changed without prior notice for product improvement.

SPECIFICATIONS

Parameters		Model	DLR-V80Q4A	DLR-V90Q4A	DLR-V112Q4A	DLR-V125Q4A	DLR-V140Q4A
Cooling capacity	kw		8.0	9.0	11.2	12.5	14.0
Heating capacity	kw		9.0	11.2	12.5	13.5	16.0
Air flow volume	m ³ /h		1200	1700	1800	1800	1800
External static pressure	Pa		0	0	0	0	0
Motor power input	W		0.1	0.15	0.15	0.15	0.15
Power supply			220V 1N~/50Hz	220V 1N~/50Hz	220V 1N~/50Hz	220V 1N~/50Hz	220V 1N~/50Hz
Connected pipe size	Liquid pipe (Φ)	mm	9.52	9.52	9.52	9.52	9.52
	Gas pipe (Φ)	mm	15.88	19.05	19.05	19.05	19.05
	Drainage pipe	mm	DN32	DN32	DN32	DN32	DN32
Noise level	dB(A)		37	40	40	40	40
Weight	kg		27	35	35	35	35
Dimensions(WxDxH)	mm		840x230x840	840x300x840	840x300x840	840x300x840	840x300x840
			955x30x955	955x30x955	955x30x955	955x30x955	955x30x955

Remark: The above designs and specifications might be changed without prior notice for product improvement.

Ceiling-floor Indoor Series



SPECIFICATIONS

Parameters		Model	DLR-V45LDA	DLR-V56LDA	DLR-V71LDA	DLR-V80LDA
Cooling capacity	kw		4.5	5.6	7.1	8.0
Heating capacity	kw		5.0	6.0	7.8	9.0
Air flow volume	m ³ /h		800	1000	1200	1300
External static pressure	Pa		0	0	0	0
Motor power input	W		80	95	140	145
Power supply			220V 1N~/50Hz	220V 1N~/50Hz	220V 1N~/50Hz	220V 1N~/50Hz
Connected pipe size	Liquid pipe (Φ)	mm	6.35	6.35	9.52	9.52
	Gas pipe (Φ)	mm	12.7	12.7	15.88	15.88
	Drainage pipe	mm	DN20	DN20	DN20	DN20
Noise level	dB(A)		38	39	40	40
Weight	kg		30	30	38	38
Dimensions(WxDxH)	mm		1016x240x630	1016x240x630	1016x240x630	1316x240x630

Remark: The above designs and specifications might be changed without prior notice for product improvement.

SPECIFICATIONS

Parameters		Model	DLR-V90LDA	DLR-V112LDA	DLR-V140LDA
Cooling capacity	kw		9.0	11.2	14.0
Heating capacity	kw		10.0	12.5	15.4
Air flow volume	m ³ /h		1400	1550	2200
External static pressure	Pa		0	0	0
Motor power input	W		200	220	255
Power supply			220V 1N~/50Hz	220V 1N~/50Hz	220V 1N~/50Hz
Connected pipe size	Liquid pipe (Φ)	mm	9.52	9.52	12.7
	Gas pipe (Φ)	mm	19.05	19.05	19.05
	Drainage pipe	mm	DN20	DN20	DN20
Noise level	dB(A)		42	46	46
Weight	kg		40	43	45
Dimensions(WxDxH)	mm		1316x240x630	1316x240x630	1616x240x630

Remark: The above designs and specifications might be changed without prior notice for product improvement.

R410A DC Inverter VRF

Low Static Pressure Duct Series



SPECIFICATIONS

Parameters		Model	DLR-V22T3A	DLR-V28T3A	DLR-V36T3A	DLR-V45T3A	DLR-V56T3A
Cooling capacity	kw		2.2	2.8	3.6	4.5	5.6
Heating capacity	kw		2.5	3.2	4.0	5.0	6.3
Air flow volume	m ³ /h		450	480	550	800	900
External static pressure	Pa		30	30	30	30	30
Motor power input	W		66	66	80	110	120
Power supply			220V 1N~/50Hz	220V 1N~/50Hz	220V 1N~/50Hz	220V 1N~/50Hz	220V 1N~/50Hz
Connected pipe size	Liquid pipe (φ)	mm	6.35	6.35	6.35	6.35	6.35
	Gas pipe (φ)	mm	9.52	9.52	9.52	12.7	12.7
	Drainage pipe	mm	DN20	DN20	DN20	DN20	DN20
Noise level		dB(A)	35	35	36	40	42
Weight	kg		13.5(14)	13.5(14)	14.5(15)	17.5(18)	17.5(18)
Dimensions(WxDxH)	mm		815x490x240	815x490x240	815x490x240	1000x490x240	1000x490x240

Remark: The above designs and specifications might be changed without prior notice for product improvement.

SPECIFICATIONS

Parameters		Model	DLR-V71T3A	DLR-V80T3A	DLR-V90T3A	DLR-V112T3A	DLR-V125T3A
Cooling capacity	kw		7.1	8.0	9.0	11.2	12.5
Heating capacity	kw		8.0	9.0	10.0	12.3	14.0
Air flow volume	m ³ /h		1280	1320	1500	1700	1800
External static pressure	Pa		30	30	30	30	30
Motor power input	W		150	160	180	280	300
Power supply			220V 1N~/50Hz	220V 1N~/50Hz	220V 1N~/50Hz	220V 1N~/50Hz (380V~3N/50Hz)	220V 1N~/50Hz (380V~3N/50Hz)
Connected pipe size	Liquid pipe (φ)	mm	9.52	9.52	9.52	9.52	9.52
	Gas pipe (φ)	mm	15.88	15.88	15.88	19.05	15.88
	Drainage pipe	mm	DN20	DN20	DN20	DN20	DN20
Noise level		dB(A)	42	42	42	46	46
Weight	kg		18.5(19)	18.5(19)	19(19.5)	31(32)	31(32)
Dimensions(WxDxH)	mm		1130x490x240	1130x490x240	1130x490x240	1715x490x240	1715x490x240

Remark: The above designs and specifications might be changed without prior notice for product improvement.

Medium Static Pressure Duct Series



SPECIFICATIONS

Parameters		Model	DLR-V45T2A	DLR-V56T2A	DLR-V71T2A	DLR-V80T2A
Cooling capacity	kw		4.5	5.6	7.1	8.0
Heating capacity	kw		5.0	6.2	8.0	9.0
Air flow volume	m ³ /h		850	920	1320	1320
External static pressure	Pa		50	50	70	70
Motor power input	W		150	150	180	180
Power supply			220V 1N~/50Hz	220V 1N~/50Hz	220V 1N~/50Hz	220V 1N~/50Hz
Connected pipe size	Liquid pipe (φ)	mm	6.35	6.35	9.52	9.52
	Gas pipe (φ)	mm	12.7	12.7	15.88	15.88
	Drainage pipe	mm	DN20	DN20	DN20	DN20
Noise level		dB(A)	38	38	42	42
Weight	kg		24(24.5)	24(24.5)	28(29)	28(29)
Dimensions(WxDxH)	mm		915x677x250	915x677x250	1110x677x250	1110x677x250

Remark: The above designs and specifications might be changed without prior notice for product improvement.

SPECIFICATIONS

Parameters		Model	DLR-V90T2A	DLR-V112T2A	DLR-V125T2A	DLR-V140T2A
Cooling capacity	kw		9.0	11.2	12.5	14.0
Heating capacity	kw		10.0	12.5	14.0	16.0
Air flow volume	m ³ /h		1700	1700	2100	2100
External static pressure	Pa		70	70	70	130
Motor power input	W		200	200	320	320
Power supply			220V 1N~/50Hz	220V 1N~/50Hz (380V~3N/50Hz)	220V 1N~/50Hz (380V~3N/50Hz)	220V 1N~/50Hz (380V~3N/50Hz)
Connected pipe size	Liquid pipe (φ)	mm	9.52	9.52	9.52	9.52
	Gas pipe (φ)	mm	19.05	19.05	19.05	19.05
	Drainage pipe	mm	DN20	DN20	DN20	DN20
Noise level		dB(A)	44	44	46	46
Weight	kg		35(37)	35(37)	42(43)	42(43)
Dimensions(WxDxH)	mm		1309x677x250	1309x677x250	1450x677x250	1450x677x250

Remark: The above designs and specifications might be changed without prior notice for product improvement.

R410A DC Inverter VRF

Slim Duct Indoor Series

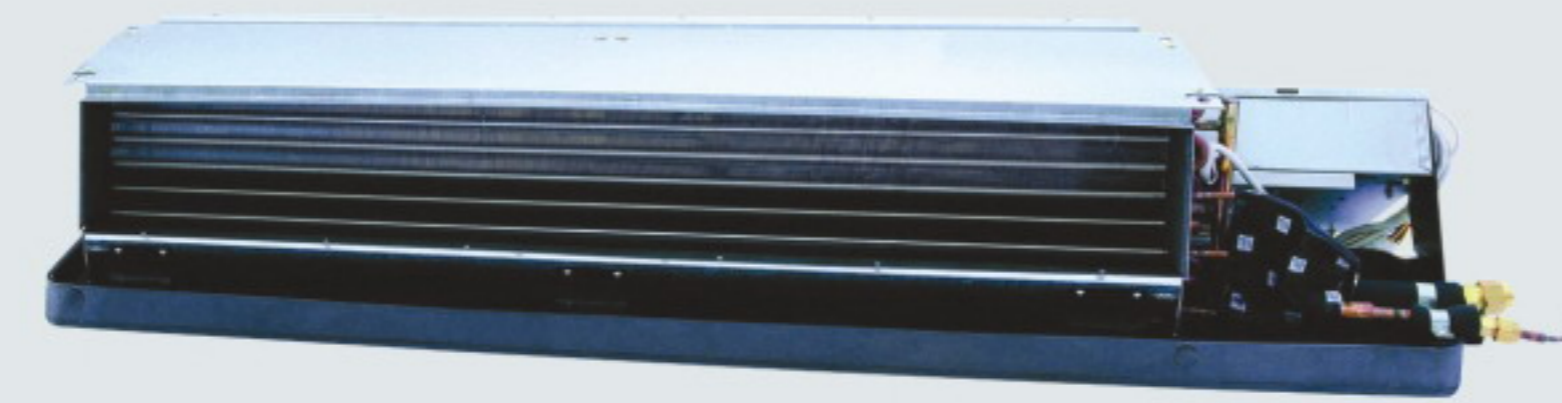

SPECIFICATIONS

Parameters		Model	DLR-V18T3A-B	DLR-V22T3A-B	DLR-V28T3A-B
Cooling capacity	kw		1.8	2.2	2.8
Heating capacity	kw		2.2	2.6	3.2
Air flow volume	m ³ /h		340	340	560
External static pressure	Pa		10	10	10
Motor power input	W		30	30	65
Power supply			220V 1N~/50Hz	220V 1N~/50Hz	220V 1N~/50Hz
Connected pipe size	Liquid pipe (φ)	mm	6.35	6.35	6.35
	Gas pipe (φ)	mm	12.7	12.7	12.7
	Drainage pipe	mm	DN20	DN20	DN20
Noise level	dB(A)		36	36	39
Weight	kg		15(17)	15(17)	16(18)
Dimensions(WxDxH)	mm		845x490x210	845x490x210	845x490x210

Remark: The above designs and specifications might be changed without prior notice for product improvement.

SPECIFICATIONS

Parameters		Model	DLR-V36T3A-B	DLR-V45T3A-B	DLR-V56T3A-B
Cooling capacity	kw		3.6	4.5	5.6
Heating capacity	kw		4.0	5.0	6.3
Air flow volume	m ³ /h		560	780	920
External static pressure	Pa		10	10	10
Motor power input	W		65	88	110
Power supply			220V 1N~/50Hz	220V 1N~/50Hz	220V 1N~/50Hz
Connected pipe size	Liquid pipe (φ)	mm	6.35	6.35	6.35
	Gas pipe (φ)	mm	12.7	12.7	12.7
	Drainage pipe	mm	DN20	DN20	DN20
Noise level	dB(A)		39	40	40
Weight	kg		16(18)	22(24)	22(24)
Dimensions(WxDxH)	mm		845x490x210	1028x490x210	1028x490x210

Remark: The above designs and specifications might be changed without prior notice for product improvement.

Wall-Mounted Indoor Series



SPECIFICATIONS

Parameters		Model	DLR-V22GA	DLR-V28GA	DLR-V36GA	DLR-V45GA	DLR-V56GA
Cooling capacity	kw		2.2	2.8	3.6	4.5	5.6
Heating capacity	kw		2.4	3.0	4.0	5.0	6.0
Air flow volume	m ³ /h		560	560	600	750	750
External static pressure	Pa		0	0	0	0	0
Motor power input	W		30	30	30	45	45.0
Power supply			220V 1N~/50Hz	220V 1N~/50Hz	220V 1N~/50Hz	220V 1N~/50Hz	220V 1N~/50Hz
Connected pipe size	Liquid pipe (φ)	mm	6.35	6.35	6.35	6.35	6.4
	Gas pipe (φ)	mm	12.7	12.7	12.7	12.7	12.7
	Drainage pipe	mm	DN20	DN20	DN20	DN20	DN20
Noise level	dB(A)		36	36	36	39	39
Weight	kg		12(13)	12(13)	12(13)	15(16)	15(16)
Dimensions(WxDxH)	mm		915x289x216	915x289x216	915x289x216	1080x315x216	1080x315x216

Remark: The above designs and specifications might be changed without prior notice for product improvement.





R410A Air-cooled Modular Chiller and Terminal

How to read the models

L S Q W R F 65 M / T B

① | ② | ③ | ④ | ⑤ | ⑥ | ⑦ | ⑧

- ①..... Water system
- ②..... Hermetic scroll
- ③..... Function Code
R:Heat Pump L:Cooling Only
- ④..... Mode Code
F:Air Cooled /:Water Cooled
- ⑤..... Capacity(65kw)
- ⑥..... Modular Chiller
- ⑦..... System Number
/:One T:Two
H:Three F:Four
- ⑧..... Design Code

1. R410A ON/OFF Unitary

2. R410A DC Inverter Unitary

3. R410A DC Inverter VRF

4. R410A Air-cooled Chiller and Terminal

5. R410A Heat Pump Water Heater



R410A Air-cooled Mini Chiller



R410A Air-cooled Modular Chiller



SPECIFICATIONS

Parameters		Model	LSQWRF12A/C	LSQWRF15A/C	LSQWRF20A/C	LSQWRF25/TC
Cooling capacity	kw		12	15	20	25
	kcal/h		10320	12900	17200	21500
Heating capacity	kw		13	16.5	21.8	28
	kcal/h		11180	14190	18748	23650
Adjustable capacity	%		0,50,100	0,50,100	0,50,100	0,50,100
Power supply			380V(220V)/50Hz	380V(220V)/50Hz	380V(220V)/50Hz	380V/50Hz
Evaporator	Type		Brazed plate heat exchanger	Brazed plate heat exchanger	Double tube type heat exchanger	Double tube type heat exchanger
	Water flow volume	m ³ /h	2.30	2.58	3.40	4.30
	Water pressure drop	kPa	50	50	40	40
	Connected pipe diameter	mm	DN25	DN25	DN25	DN25
Condensing fan	Type		Efficient axial-flow	Efficient axial-flow	Efficient axial-flow	Efficient axial-flow
	Air flow type		Horizontal	Horizontal	Horizontal	Horizontal
Refrigerant oil	Type		SUNISO-4GSD	SUNISO-4GSD	SUNISO-4GSD	SUNISO-4GSD
	Charge volume	L	1.4	1.4	2.4	2.8
Refrigerant	Type		R410A	R410A	R410A	R410A
	Throttle mode		Capillary tube or thermal expansion valve	Capillary tube or thermal expansion valve	Thermal expansion valve	Thermal expansion valve
	Charge volume	kg	4.2	5	7.2	8.4
Dimension	Width	mm	1000	1000	1200	1200
	Depth	mm	450	450	620	620
	Height	mm	1530	1530	1820	1820
Unit noise level	dB(A)		60	60	65	65
Unit weight	kg		200	210	290	290

Remark: The above designs and specifications might be changed without prior notice for product improvement.

Features

- Special design for air-cooled chiller system.
- Small capacity difference between each model.
- Spray-paint for copper pipes.
- Modular design: max. 16 outdoor can be combined together.

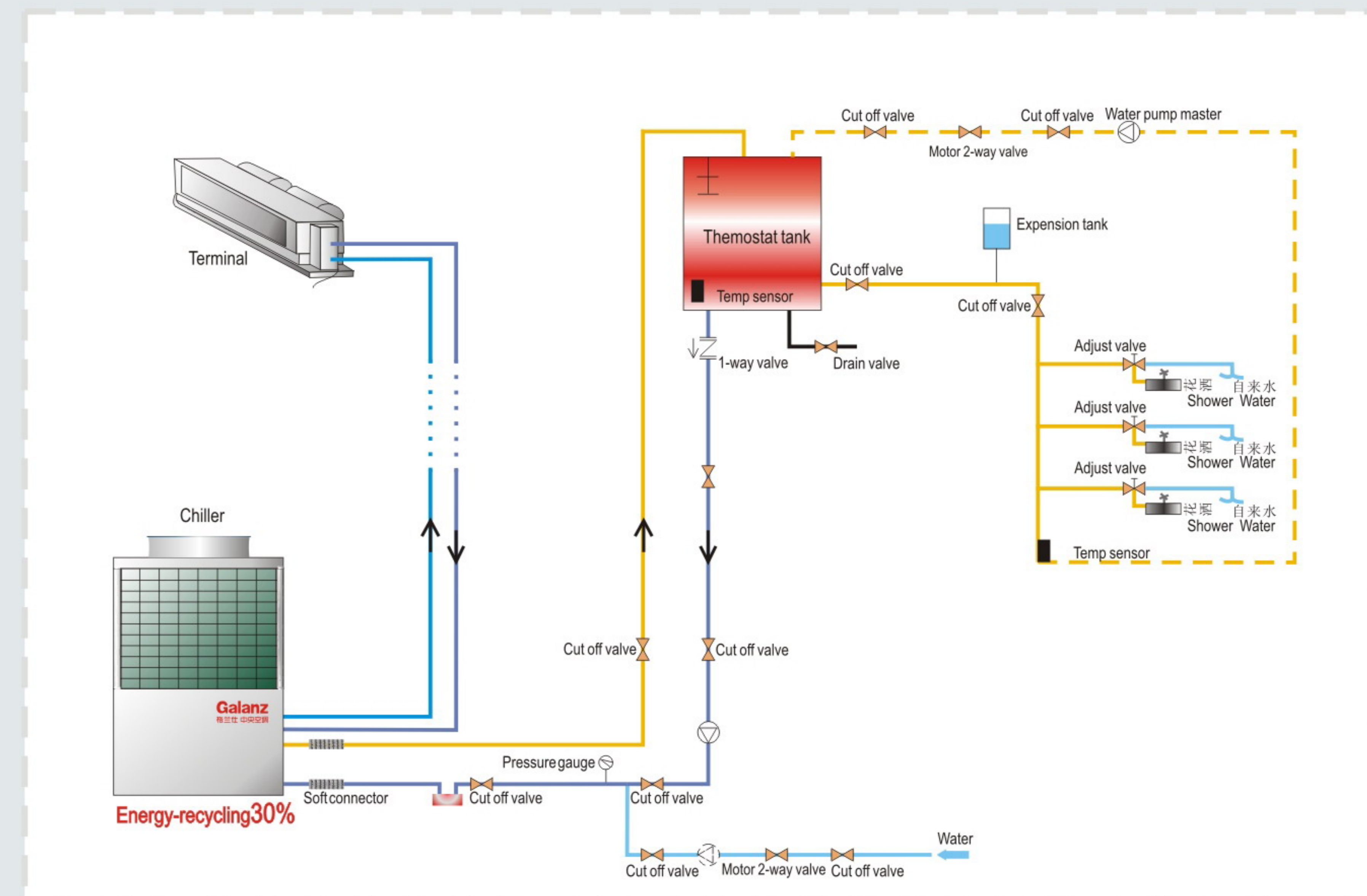



- E-Control part can be opened easily, makes installation and maintenance more convenient
- Multi control solution, wire controller, touch-screen controller
- Multi system protection for safe performance
- Intelligent auto defrosting



Max
16 Modules
Combined



Terminals (Fan Coil Unit) How to read the models

SPECIFICATIONS

Parameters	Model	LSQWRF30AM/T-B	LSQWRF40AM/T-B	LSQWRF50AM/T-B	LSQWRF65AM/T-B	LSQWRF75AM/T-B	LSQWRF100AM/T-B	LSQWRF130AM/T-B	LSQWRF150AM/T-B	LSQWRF200AM/T-B	
		LSQWRF30AM/T-B	LSQWRF40AM/T-B	LSQWRF50AM/T-B	LSQWRF65AM/T-B	LSQWRF75AM/T-B	LSQWRF100AM/T-B	LSQWRF130AM/T-B	LSQWRF150AM/T-B	LSQWRF200AM/T-B	
Cooling capacity	kw	30	40	50	65	75	100	130	150	200	
	kcal/h	25800	34400	43000	55900	64500	86207	111800	129000	172000	
Heating capacity	kw	32.5	43.5	54	70	81	108	140	165	216	
	kcal/h	27950	37410	46440	60200	69660	93103	120400	141900	185760	
Adjustable capacity	%	0.50,100	0.50,100	0.50,100	0.50,100	0.50,100	0.50,100	0.50,100	0.50,100	0.50,100	
Power supply		380V/50Hz	380V/50Hz	380V/50Hz	220V/50Hz	380V/50Hz	380V/50Hz	380V/50Hz	380V/50Hz	380V/50Hz	
Evaporator	Type	Brazen plate heat exchanger									
	Water flow volume	m ³ /h	5.16	6.90	8.60	11.20	12.90	17.2	22.30	25.80	34.40
	Water pressure drop	kPa	50	50	50	50	50	50	50	50	50
	Connected pipe diameter	mm	DN32	DN32	DN40	DN40	DN40	DN40	DN40	DN40	DN40
Condensing fan	Type	Efficient axial-flow									
	Air flow type	Top									
Refrigerant oil	Type	FV68S									
	Charge volume	L	2x1.7	2x1.7	4x2	4x2	4x2	6x2	4x3.3	4x3.6	4x6.7
Refrigerant	Type	R410A									
	Throttle mode	thermal expansion valve									
	Charge volume	kg	2x4.2	2x4.9	2x10	2x10.5	2x11	2x13.5	2x18	2x21	2x27
Dimension	Width	mm	1160	1160	2060	2060	2060	2460	2310	2310	2310
	Depth	mm	950	950	1030	1030	1030	1030	2000	2000	2000
	Height	mm	1860	1860	2030	2030	2030	1980	2030	2005	2005
Unit noise level		dB(A)	65	685	68	68	68	70	72	72	72
Unit weight		kg	400	410	740	760	800	940	1300	1600	1700

Remark: The above designs and specifications might be changed without prior notice for product improvement.

F P 800 WA

- ①..... Fan coil unit
 - ②..... Capacity
 - ③..... Type
- WA:duct type Q4M:cassette type
LDM:Ceiling floor type

Ducted Type Fan Coil Unit



Features

1. Various choices for air volume, static pressure, which can meet different needs of project.
2. Drip tray special design, electronic control box leftward coherent design, easy installation and maintenance.
3. Stable air flow with little turbulence.
4. Three fan speed selectable.
5. Thin body, saving space design.

SPECIFICATIONS

Parameters		Model	FP200WA	FP300WA	FP400WA	FP500WA	FP600WA
Rated Air volume	≥m³/h	H	340	510	680	850	1020
		M	280	380	515	660	765
		L	180	260	340	430	530
Rated cooling capacity	kw	H	1800	2700	3600	4500	5400
		M	1500	2460	3000	3716	4424
		L	1391	2057	2479	2921	3793
Rated heating capacity	kw	H	2700	4050	5400	6750	8100
		M	1949	2770	3939	4902	5694
		L	1298	1774	2780	3505	3876
Fan	Type		Double tube type heat exchanger	Double tube type heat exchanger	Double tube type heat exchanger	Double tube type heat exchanger	Double tube type heat exchanger
	External static pressure Pa	Blow free type	0	0	0	0	0
		Standard type	12	12	12	12	12
High pressure type		30	30	30	30	30	
Power supply			220V 50Hz /Single Phase	220V 50Hz /Single Phase	220V 50Hz /Single Phase	220V 50Hz /Single Phase	220V 50Hz /Single Phase
Power input w	Blow free type		35	40	45	68	90
	Standard type		37	52	62	76	96
	High pressure type		44	59	72	87	108
Heat exchanger		Type	Cooper tube & Aluminium Fins	Cooper tube & Aluminium Fins	Cooper tube & Aluminium Fins	Cooper tube & Aluminium Fins	Cooper tube & Aluminium Fins
figure dimension	Unit WxHxD	mm	815x230x475	815x230x475	998x230x475	998x230x475	1128x230x475
	Packing WxHxD	mm	845x530x275	845x530x275	1030x530x275	1030x530x275	1160x530x275
Piping sizes	Water inlet/outlet pipe	mm	Rc 3/4" / Rc 3/4"	Rc 3/4" / Rc 3/4"	Rc 3/4" / Rc 3/4"	Rc 3/4" / Rc 3/4"	Rc 3/4" / Rc 3/4"
	Drainage pipe	mm	R 3/4"	R 3/4"	R 3/4"	R 3/4"	R 3/4"
Noise level dB(A)		Blow free type	≤36	≤37	≤38	≤42	≤44
		Standard type	≤37	≤39	≤41	≤43	≤45
		High pressure type	≤40	≤42	≤44	≤46	≤47
Net/Gross weight		kg	15/17	18/20	21/23	23/25	32/34
Qty' per 20' /40' / 40'HQ			220/444/498	220/444/498	174/364/408	174/364/408	174/348/390

Remark: The above designs and specifications might be changed without prior notice for product improvement.

SPECIFICATIONS

Parameters		Model	FP700WA	FP800WA	FP1000WA	FP1200WA	FP1400WA
Rated Air volume	≥m³/h	H	1200	1360	1700	2040	2380
		M	910	1040	1280	1550	1800
		L	610	710	860	1050	1190
Rated cooling capacity	kw	H	6300	7200	9000	10800	12600
		M	5630	6435	7848	9296	10623
		L	4905	5605	7053	8534	8056
Rated heating capacity	kw	H	9500	10800	13500	16200	18900
		M	6996	7924	10473	12997	16807
		L	4827	5421	6992	8645	13422
Fan	Type		Double tube type heat exchanger	Double tube type heat exchanger	Double tube type heat exchanger	Double tube type heat exchanger	Double tube type heat exchanger
	External static pressure Pa	Blow free type	0	0	0	0	0
		Standard type	12	12	12	12	12
High pressure type		30	30	30	30	30	
Power supply			220V 50Hz /Single Phase	220V 50Hz /Single Phase	220V 50Hz /Single Phase	220V 50Hz /Single Phase	220V 50Hz /Single Phase
Power input w	Blow free type		100	122	150	185	222
	Standard type		113	134	152	189	228
	High pressure type		134	152	174	212	253
Heat exchanger		Type	Cooper tube & Aluminium Fins	Cooper tube & Aluminium Fins	Cooper tube & Aluminium Fins	Cooper tube & Aluminium Fins	Cooper tube & Aluminium Fins
figure dimension	Unit WxHxD	mm	1369x230x475	1500x230x475	1500x230x475	1714x230x475	1995x230x475
	Packing WxHxD	mm	1399x530x275	1530x530x275	1530x530x275	1745x530x275	2025x530x275
Piping sizes	Water inlet/outlet pipe	mm	Rc 3/4" / Rc 3/4"	Rc 3/4" / Rc 3/4"	Rc 3/4" / Rc 3/4"	Rc 3/4" / Rc 3/4"	Rc 3/4" / Rc 3/4"
	Drainage pipe	mm	R 3/4"	R 3/4"	R 3/4"	R 3/4"	R 3/4"
Noise level dB(A)		Blow free type	≤44	≤44	≤46	≤47	≤52
		Standard type	≤45	≤46	≤48	≤50	≤52
		High pressure type	≤47	≤48	≤50	≤52	≤54
Net/Gross weight		kg	32/36	35/39	39/42	42/45	48/52
Qty' per 20' /40' / 40'HQ			124/258/288	106/234/261	106/234/261	104/210/231	86/180/201

Remark: The above designs and specifications might be changed without prior notice for product improvement.

Cassete Type Fan Coil Unit



Features

1. Four way air flow that goes to every corner of the house.
2. Front panel design and elegant appearance.
3. Three dimensional screw fan makes stable air flow.
4. Three Fan speed selectable.
5. Low noise level, that is suitable for office/school project.

SPECIFICATIONS

Parameters		Model	FP-51Q4M	FP-68Q4M	FP-85Q4M	FP-102Q4M	FP-120Q4M	FP-136Q4M	FP-170Q4M
Rated Air volume	≥m³/h	H	510	680	850	1020	1200	1360	1700
		M	380	515	660	765	910	1040	1280
		L	260	340	430	530	610	710	860
Rated cooling capacity	kw	H	2.7	3.6	4.5	5.4	6.3	7.2	9
		M	2.5	3.0	3.7	4.4	5.6	6.4	7.8
		L	2.1	2.5	2.9	3.8	4.9	5.6	7.1
Rated heating capacity	kw	H	4.05	5.4	6.75	8.1	9.5	10.8	13.5
		M	2.8	4.0	4.9	5.7	7	7.9	10.5
		L	1.8	2.8	3.5	3.9	4.8	5.4	7.0
Power supply		220V/50Hz	220V/50Hz	220V/50Hz	220V/50Hz	220V/50Hz	220V/50Hz	220V/50Hz	220V/50Hz
Motor power supply	W	40	65	75	110	140	160	200	
Heat exchanger	Type		centrifugal	centrifugal	centrifugal	centrifugal	centrifugal	centrifugal	centrifugal
	running pressure		≤1.6MPa	≤1.6MPa	≤1.6MPa	≤1.6MPa	≤1.6MPa	≤1.6MPa	≤1.6MPa
	Water	m³h	0.46	0.62	0.77	0.93	1.08	1.24	1.55
	Water	kPa	23	26	28	35	35	38	38
Dimensions	Body	Width mm	580	580	580	840	840	840	840
		Depth mm	580	580	580	840	840	840	840
		Height mm	290	290	290	230	230	300	300
	ABS panel	Width	650	650	650	953	953	953	953
		Depth	650	650	650	953	953	953	953
		Height	60	60	60	60	60	60	60
Connected pipe size	Water	mm	DN20	DN20	DN20	DN20	DN20	DN20	DN20
	Drainage	mm	DN25	DN25	DN25	DN25	DN25	DN25	DN25
Noise level		dB(A)	39	41	43	44	46	53	55
Weight		kg	22	22	28	28	28	40	40
Net/Gross weight		kg	15/17	18/20	21/23	23/25	32/34		
Qty' per 20' /40' / 40'HQ			220/444/498	220/444/498	174/364/408	174/364/408	174/348/390		

Remark: The above designs and specifications might be changed without prior notice for product improvement.

Ceiling Floor Type Fan Coil Unit



SPECIFICATIONS

Parameters		Model	FP400LDM	FP600LDM	FP800LDM	FP1000LDM	FP1200LDM	FP1400LDM
Rated Air volume	≥m³/h	H	680	1020	1360	1700	2040	2380
		M	530	950	1060	1520	1600	1800
		L	400	660	710	1080	1400	1190
Rated cooling capacity	kw	H	3.6	5.4	7.7	9.3	9.2	12.1
		M	2.9	4.6	7.6	8.1	9.2	11.7
		L	2.6	3.9	7.4	7.9	9.0	10.3
Rated heating capacity	kw	H	4.7	8.1	11.6	13.9	14.1	16.5
		M	3.6	5.9	8.2	10.8	12.6	13.2
		L	2.7	4.1	5.6	7.2	10.8	11.3
Power supply		220V/50Hz	220V/50Hz	220V/50Hz	220V/50Hz	220V/50Hz	220V/50Hz	
Motor power supply	W	44	155	192	243	245	292	
Heat exchanger	Fan type		Centrifugal	Centrifugal	Centrifugal	Centrifugal	Centrifugal	Centrifugal
	running pressure		≤1.6MPa	≤1.6MPa	≤1.6MPa	≤1.6MPa	≤1.6MPa	≤1.6MPa
	Water	m³h	0.46	0.93	1.32	1.55	1.76	2.17
	Water	kPa	26	35	38	38	38	40
Dimensions	Body	Width mm	1016	1016	1316	1316	1316	1616
		Depth mm	240	240	240	240	240	243
		Height mm	630	630	630	630	630	630
Connected pipe size	Water	mm	Rc3/4"	Rc3/4"	Rc3/4"	Rc3/4"	Rc3/4"	Rc3/4"
	Drainage	mm	DN25	DN25	DN25	DN25	DN25	DN25
Noise level		dB(A)	42	46	49	49	49	52
Weight		kg	32	34	45	45	45	56
Type			Cooper tube&Aluminium Fins					

Remark: The above designs and specifications might be changed without prior notice for product improvement.



R410A Heat Pump Water Heater How to read the models

G R S - 3.5 H X A D F
 ① ② ③ ④ ⑤ ⑥ ⑦ ⑧

- ①..... **Galanz**
- ②..... **Air Source Heat Pump Heater**
- ③..... **Capacity(3.5KW)**
- ④..... **Application Type**
H:Residential S:Commercial
- ⑤..... **Circuling Water Heating**
- ⑥..... **Refrigerant**
A:R410A /:R22
- ⑦..... **Power Supply**
D:220V 50HZ 1PH /:380V 50HZ 3PH
- ⑧..... **System Type**
F:Packaged Type without water tank
W:Split type with water tank

- 1. R410A ON/OFF Unitary
- 2. R410A DC Inverter Unitary
- 3. R410A DC Inverter VRF
- 4. R410A Air-cooled Chiller and Terminal
- 5. R410A Heat Pump Water Heater



Air source hot water heat pump



Heating COP Curve

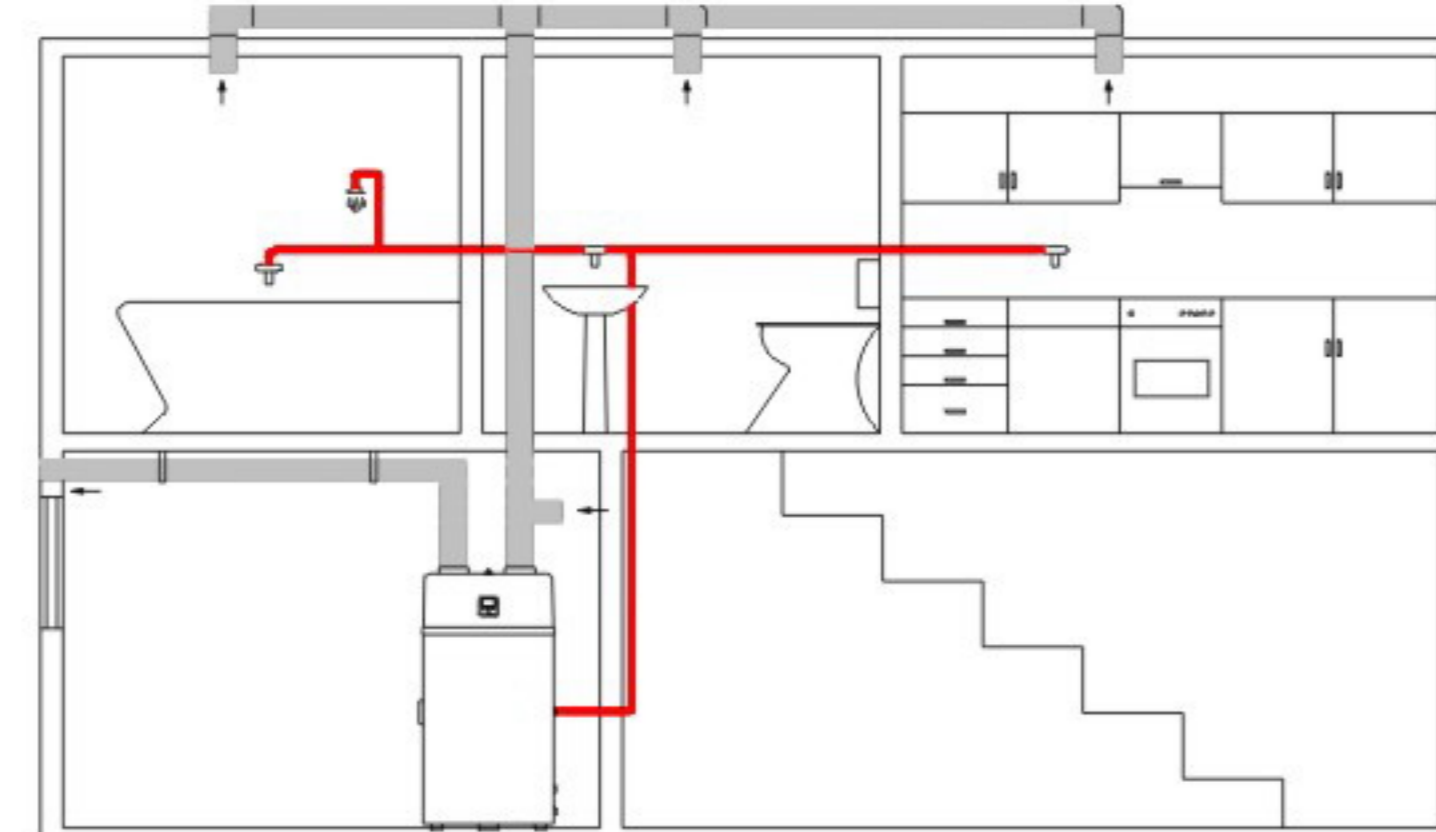
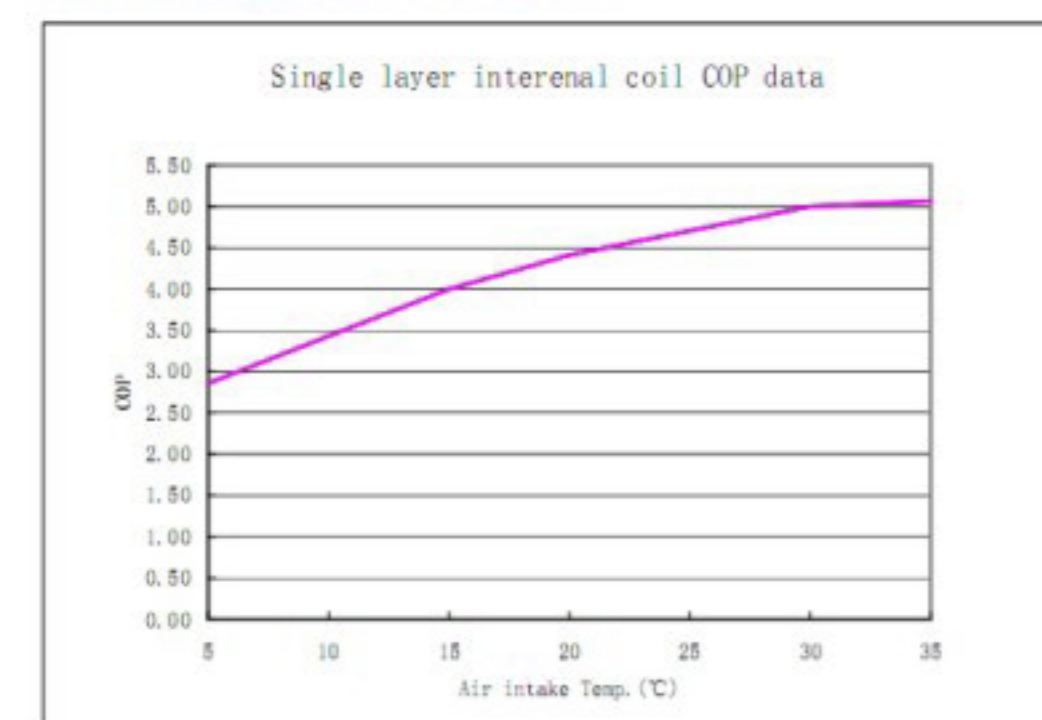

Water Source Heat Pump

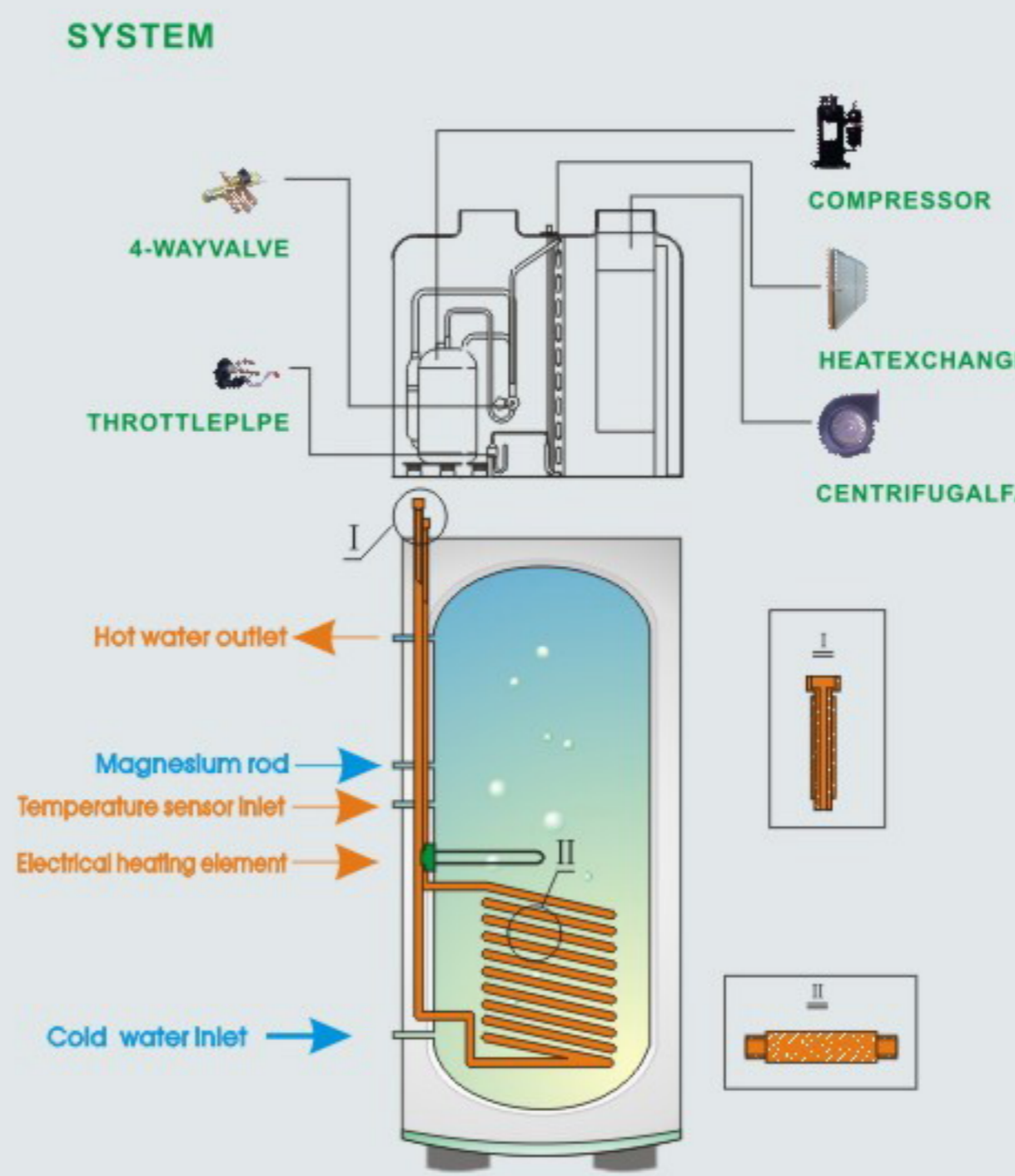

SPECIFICATION ----- Double layer internal coil pipe

Model		EH-3BC-100LD	EH-3BC-150LD	EH-3BC-200LD	EH-3CC-200LD	EH-3CC-260LD	EH-3CC-300LD
Rated Heating Capacity	W	3000	3000	3000	3000	3000	3000
	BTU/h	10500	10500	10500	10500	10500	10500
Electric Auxiliary heating	W	Optional					
Power Supply	V/PH/Hz	220V/1PH/50Hz					
Input Power	KW	0.83	0.83	0.83	0.83	0.83	0.83
Running Current	A	3.8	3.8	3.8	3.8	3.8	3.8
Hot Water Produced Volume	L/h	70	70	70	70	70	70
Water Tank Volume	L	100	150	200	200	260	300
Thermostat Factory Setting	°C	50°C ~ 55°C					
Thermostat Maximum Setting	°C	65°C					
Compressor type		Rotary					
Air filter		NO	NO	NO	YES	YES	YES
Defrosting function*		Optional					
Working temperature (with defrosting function):	°C	-15-43 °C					
Working temperature (without defrosting function):	°C	5-43 °C					
Air Duct Diameter		Φ145mm					
Fan Motor type		AC centrifugal blower single inlet					
Fan Motor Input	W	50	50	50	50	50	50
Noise	dB(A)	43	43	43	43	43	43
Unit Dimension	H	1140	1450	1760	1410	1670	1810
	Diameter(Φ)	570	570	650	650	650	650
Packing Dimension	H	1220	1530	1840	1490	1570	1890
	W	650	650	650	690	690	690
	D	650	650	650	690	690	690
Weight	Net weight	56	64	72	72	90	102
	Gross weight	66	74	82	87	105	117
Loading QTY (20/40)	Sets	27/54			24/48		

The specification with testing condition
 Dry ambient Temp. : 20 °C Wet ambient Temp. : 15 °C Water inlet Temp. : 15 °C

SPECIFICATION ----- Single layer internal coil pipe

Model		EH-3BC-200L	EH-4BC-200L	EH-4CC-200L	EH-4CC-260L	EH-4CC-300L	EH-5.3CC-300L
Rated Heating Capacity	W	3000	4000	4000	4000	4000	5300
	BTU/h	10500	13700	13700	13700	13700	18000
Electric Auxiliary heating	W	Optional					
Power Supply	V/PH/Hz	220V/1PH/50Hz					
Input Power	KW	0.68	0.91	0.91	0.91	0.91	1.28
Running Current	A	3.2	4.3	4.3	4.3	4.3	6.1
Hot Water Produced Volume	L/h	70	90	90	90	90	110
Water Tank Volume	L	200	200	200	260	300	300
Thermostat Factory Setting	°C	50°C ~ 55°C					
Thermostat Maximum Setting	°C	65°C					
Compressor type		Rotary					
Air filter		NO	NO	YES	YES	YES	YES
Defrosting function*		Optional					
Working temperature (with defrosting function):	°C	-15-43 °C					
Working temperature (without defrosting function):	°C	5-43 °C					
Air Duct Diameter		Φ145mm					
Fan Motor type		AC centrifugal blower single inlet					
Fan Motor Input	W	50	60	60	60	60	80
Noise	dB(A)	43	43	43	43	43	43
Unit Dimension	H	1760	1760	1410	1670	1810	1810
	Diameter(Φ)	570	570	650	650	650	650
Packing Dimension	H	1840	1840	1490	1750	1890	1890
	W	640	640	690	690	690	690
	D	640	640	690	690	690	690
Weight	Net weight	73	73	79	86	91	99
	Gross weight	79	84	86	92	97	105
Loading QTY (20/40)	Sets	27/54			24/48		

The specification with testing condition
 Dry ambient Temp. : 20 °C Wet ambient Temp. : 15 °C Water inlet Temp. : 15 °C

SPECIFICATION ----- External coil pipe

Model		EH-3BC-100LE	EH-3BC-150LE	EH-3BC-200LE	EH-3CC-200LE	EH-3CC-260LE	EH-3CC-300LE
Rated Heating Capacity	W	3000	3000	3000	3000	3000	3000
	BTU/h	10500	10500	10500	10500	10500	10500
Electric Auxiliary heating	W	Optional					
Power Supply	V/PH/Hz	220V/1PH/50Hz					
Input Power	KW	0.88	0.88	0.88	0.88	0.88	0.88
Running Current	A	4.0	4.0	4.0	4.0	4.0	4.0
Hot Water Produced Volume	L/h	70	70	70	70	70	70
Water Tank Volume	L	100	150	200	200	260	300
Thermostat Factory Setting	°C	50°C ~ 55°C					
Thermostat Maximum Setting	°C	65°C					
Compressor type		Rotary					
Air filter		NO	NO	NO	YES	YES	YES
Defrosting function*		Optional					
Working temperature (with defrosting function):	°C	-15-43 °C					
Working temperature (without defrosting function):	°C	5-43 °C					
Air Duct Diameter		Φ145mm					
Fan Motor type		AC centrifugal blower single inlet					
Fan Motor Input	W	50	50	50	50	50	50
Noise	dB(A)	43	43	43	43	43	43
Unit Dimension	H	1140	1450	1760	1410	1670	1810
	Diameter(Φ)	570	570	650	650	650	650
Packing Dimension	H	1220	1530	1840	1490	1570	1890
	W	650	650	650	690	690	690
	D	650	650	650	690	690	690
Weight	Net weight	51	59	67	67	85	97
	Gross weight	61	69	77	89	97	109
Loading QTY (20/40)	Sets	27/54			24/48		

The specification with testing condition
 Dry ambient Temp. : 20 °C Wet ambient Temp. : 15 °C Water inlet Temp. : 15 °C

